

PROPERTY REPORT

Property ID: -130745203

Property Name: 90 Halsey Reed Road
Address: 90 Halsey Reed RD

Ownership: Private
Apartment #: **ZIP:** 08512

PROPERTY LOCATION(S):

County:	Municipality:	Local Place Name:	USGS Quad:	Block:	Lot:
MIDDLESEX	Cranbury township	Cranbury	Hightstown	13	5

Property Photo:



Old HSI Number:

NRIS Number:

HABS/HAER Number:

Description:

90 Halsey Reed Road is a two-story-tall, four-bay-wide, two-bay-deep, frame dwelling built circa 1880 in the Greek Revival. The dwelling consists of a side-gabled main block, with a two-story, rear (west) ell and a hipped-roof, enclosed porch extending from the south elevation of the main block (likely added in the early twentieth century). The roof is sheathed in asphalt shingles. An exterior, brick chimney extends above the north gable end. The exterior of the dwelling is clad in aluminum siding. Windows throughout consist of one-over-one, vinyl-sash replacement units, flanked by inoperable vinyl shutters on the primary (east) elevation of the main block. The primary elevation has symmetrical fenestration. The central, primary entrance contains a metal storm door and wood panel door, set within a wood surround featuring a segmented transom and sidelights and topped by a broken pediment (historic, likely original). The entrance is accessed by a brick stoop with metal railings. The north elevation of the main block has symmetrical fenestration. The south gable end of the main block contains a louvered metal vent, with paired vinyl-sash windows on the first floor of the rear ell. The hipped-roof porch is enclosed with wood screen windows (possibly historic) and is supported by narrow wood columns. The rear elevation is not visible from the public right-of-way. The dwelling stands atop a fieldstone foundation.

An early twentieth-century, two-story-tall, two-bay-wide, frame garage stands approximately 45 feet west of the dwelling. An asphalt-shingle, front-gabled roof tops the garage. Aluminum siding clads the exterior. On the primary (east) elevation, the garage contains two paneled wood roll-top doors beside a wood-plank door with four inset lights. In the primary gable end, there are two one-over-one windows flanked by inoperable, vinyl louvered shutters.

Character-defining elements of the dwelling consist of its massing, wood frieze with gable-end returns, and wood door surround with a broken pediment.

History: 90 Halsey Reed Road stylistically dates to circa 1880 and is an example of a Greek Revival-style dwelling in Cranbury. The dwelling does not appear on an 1876 map of Cranbury (Everts & Stewart 1876). Sometime during the early twentieth century, a hipped-roof porch was added to the south elevation of the main block, and a one-story, detached garage was constructed west of the dwelling. Aerial photographs throughout the second half of the twentieth century and into the twenty-first century depict the dwelling in its current footprint (NETR 1940, 1957, 1979, 1987, 1995, 2002). Sometime during the late twentieth century, the dwelling's current siding and windows were installed.

Survey Name: Cranbury Historic Sites Survey Phase III

Surveyor: Matthew Goldberg

Organization: Richard Grubb & Associates, Inc.

☒ (Primary Contact)

Property ID:

-130745203

Page 1

Setting:

90 Halsey Reed Road is sited on two irregularly shaped parcels (Block 13, Lots 3 and 4) located on the west side of Halsey Reed Road in Cranbury Township, Middlesex County, New Jersey. The dwelling is oriented with its primary elevation facing east and is set back approximately 20 feet from the road. An asphalt driveway leads from the roadway to the garage and a flagstone path leads from the roadway to the primary entrance. Shrubs and hardwood trees are planted in close proximity to the dwelling. A wood fence borders the rear yard of the property. The subject property is located in a residential neighborhood surrounded by properties dating from the mid-nineteenth to the early twentieth centuries.

**Registration
and Status
Dates:**
National Historic Landmark?: ☐
National Register:
New Jersey Register:
Determination of Eligibility:
Certification of Eligibility:
SHPO Opinion:
Local Designation: 12/13/2021

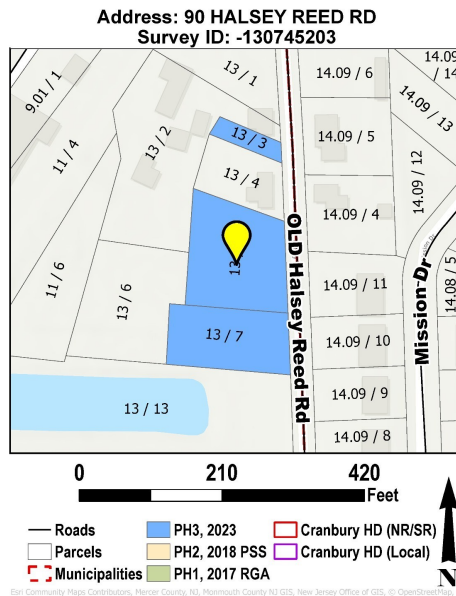
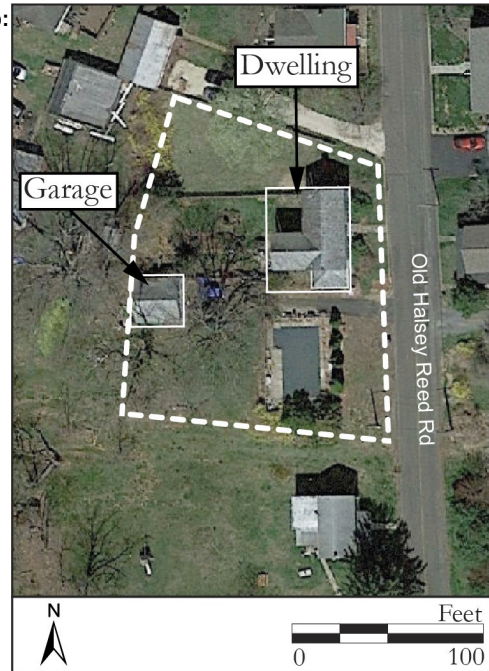
Other Designation:
Other Designation Date:
☐ **Eligibility Worksheet included in present survey?**
☐ **Is this Property an identifiable farm or former farm?**
Location Map:**Site Map:****BIBLIOGRAPHY:**

Author:	Title:	Year:	HPO Accession #: (if applicable)
Everts & Stewart	Combination Atlas Map of Middlesex County, New Jersey. Everts & Stewart, Philadelphia, Pennsylvania.	1876	
Middlesex County Clerk's Office	On file, Middlesex County Clerk's Office, New Brunswick, New Jersey.		
Nationwide Environmental Title Research	Historic Aerial Photograph. Electronic document, http://www.historicaerials.com , accessed June 2023.	1940	
Nationwide Environmental Title Research	Historic Aerial Photograph. Electronic document, http://www.historicaerials.com , accessed June 2023.	1957	
Nationwide Environmental Title Research	Historic Aerial Photograph. Electronic document, http://www.historicaerials.com , accessed June 2023.	1979	
Nationwide Environmental Title Research	Historic Aerial Photograph. Electronic document, http://www.historicaerials.com , accessed June 2023.	1987	
Nationwide Environmental Title Research	Historic Aerial Photograph. Electronic document, http://www.historicaerials.com , accessed June 2023.	1995	
Nationwide Environmental Title Research	Historic Aerial Photograph. Electronic document, http://www.historicaerials.com , accessed June 2023.	2002	

Survey Name: Cranbury Historic Sites Survey Phase III

Surveyor: Matthew Goldberg

Organization: Richard Grubb & Associates, Inc.

☒ (Primary Contact)

Property ID:
-130745203

Page 2

Additional Information:

90 Halsey Reed Road was identified in the 2021 Designation of the Cranbury Station Hamlet Historic District and evaluated as a contributing resource under Criterion C (PPGLH 2021:16). Richard Grubb & Associates, Inc. recommends 90 Halsey Reed Road as a contributing resource to the Cranbury Station Hamlet Historic District due to its date of construction and design. The dwelling retains sufficient integrity of materials, design, workmanship, setting, location, feeling, and association to convey the significance of the historic district.

More Research Needed? ☐ (checked=Yes)

INTENSIVE-LEVEL USE ONLY:

Attachments Included:

0 Building	0 Bridge
0 Structure	0 Landscape
0 Object	0 Industry

Historic District ? ☒

District Name: Cranbury Station Hamlet Historic District

Status: Contributing

Associated Archeological Site/Deposits? ☐

(known or potential sites. If Yes, please describe briefly)

Conversion Problem? ☐ ConversionNote: 1202_13_5

Date form completed: 6/21/2023

Survey Name: Cranbury Historic Sites Survey Phase III

Surveyor: Matthew Goldberg

Organization: Richard Grubb & Associates, Inc.

☒ (Primary Contact)

Property ID:

-130745203

Page 3

PROPERTY REPORT: PHOTO CONTINUATION SHEET

Property ID: -130745203

Property Name: 90 Halsey Reed Road

Address: 90 Halsey Reed RD



Photo 2



Photo 3

Property Name: 90 Halsey Reed Road

Address: 90 Halsey Reed RD



Photo 4