

## PROPERTY REPORT

Property ID: -635474467

**Property Name:** 12A Station Road

**Ownership:** Private

**Address:** 12 Station RD

**Apartment #:**

**ZIP:** 08512

### PROPERTY LOCATION(S):

County:	Municipality:	Local Place Name:	USGS Quad:	Block:	Lot:
MIDDLESEX	Cranbury township	Cranbury	Hightstown	18	13

### Property Photo:



**Old HSI Number:**

**NRIS Number:**

**HABS/HAER Number:**

### Description:

12A Station Road is a two-story-tall, frame building constructed circa 1875 as a barn and converted into a dwelling in the mid-twentieth century. The dwelling consists of a side-gabled main block with a one-story, flat-roof addition to the west (constructed circa 1924), and a one-story, flat-roof addition to the rear (south south) (constructed circa 1999). The roof of the main block is accented by overhanging eaves and is clad in asphalt shingles. An exterior, concrete block chimney is centered on the east elevation. The exterior of the dwelling is clad in wood board and batten siding. Windows are generally one-over-one and fixed vinyl-sash replacement units, set within wood surrounds. The primary (north) elevation has asymmetrical fenestration with a pent roof overhang sheltering the first floor. The primary entrance is not visible from the public right of way. The east, west, and rear elevations are not visible from the public right-of-way.

A circa-1970, one-story-tall, flat-roof outbuilding sits approximately 12 feet south of the subject building. The outbuilding is not visible from the public right-of-way.

The building at 12A Station Road was constructed circa 1875 as a barn associated with the circa-1875 house at 12B-C Station Road. The 1876 Everts & Stewart Combination Atlas Map of Middlesex County, New Jersey identifies the dwelling at 12B-C Station Road as owned by "E. Mount" (Everts and Stewart 1876). The subject building first appears cartographically on a 1916 Sanborn map of Cranbury, depicted as a two-story-tall, frame outbuilding with two one-story wings on its east elevation (Sanborn Map Company 1916). A 1933 Sanborn map indicates that the main block of the subject building functioned as a dairy, with a one-story, frame addition to the west that operated as an auto garage (Sanborn Map Company 1933). During the mid-twentieth century, the two east wings of the building were raised to two stories and the building was converted into a residence (Heritage Studies 1989). Around 1970, a one-story outbuilding was constructed behind the subject building (NETR 1970). According to a 1991 deed, the building was converted to a multi-family residence by the late twentieth century (MCCO 1991 Deed Book 3903:855). Around 1999, a one-story, flat-roof addition was added to the rear of the dwelling (NETR 1995, 2002). The extant vinyl-sash windows were likely installed during the late twentieth or early twenty-first century. The dwelling appears to have undergone little to no alterations in recent years.

### Setting:

12A Station Road is sited on an irregularly shaped parcel (Block 18, Lot 13) located on the south side of Station Road in Cranbury Township, Middlesex County, New Jersey. The dwelling is oriented with its primary elevation facing north and is set back approximately

**Survey Name:** Cranbury Historic Sites Survey Phase III

**Surveyor:** Spencer Rubino

**Organization:** Richard Grubb & Associates, Inc.

☒ (Primary Contact)

**Property ID:**

-635474467

Page 1

130 feet from the road. An asphalt-paved driveway intersects Station Road and extends to the north elevation of the subject dwelling. Mature trees and shrubs are planted within close proximity to the dwelling. The subject dwelling is located in a residential neighborhood surrounded by properties generally dating from the mid-nineteenth to the late twentieth centuries.

**Registration and Status Dates:**

**National Historic Landmark?:** ☐

**National Register:** 9/18/1980

**New Jersey Register:** 8/9/1979

**Determination of Eligibility:** 3/25/1977

**Certification of Eligibility:**

**SHPO Opinion:**

**Local Designation:** 9/26/1988

**Other Designation:**

**Other Designation Date:**

☐ **Eligibility Worksheet included in present survey?**

☐ **Is this Property an identifiable farm or former farm?**

**Location Map:**

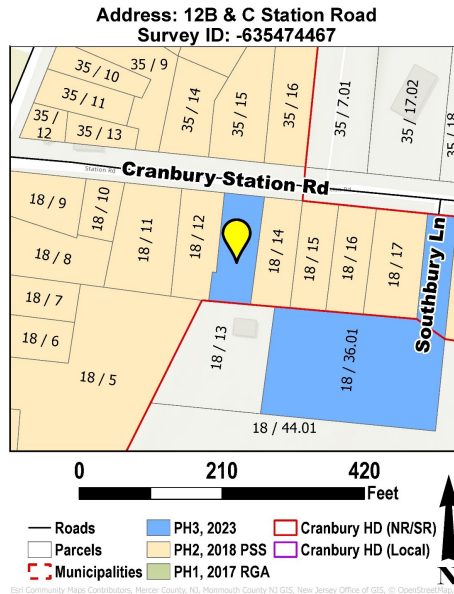

**Site Map:**

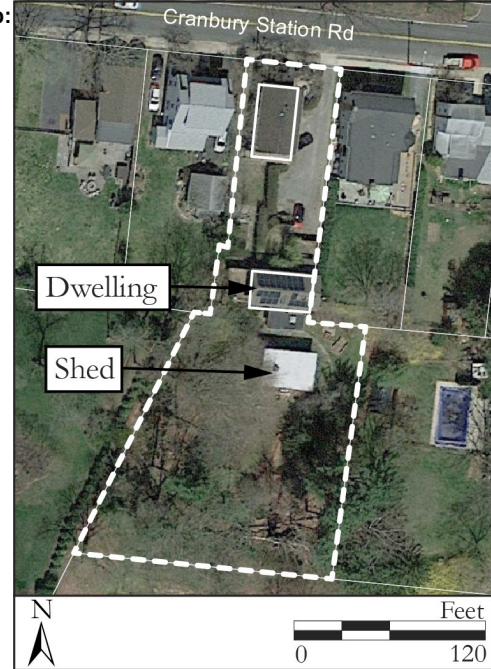

**BIBLIOGRAPHY:**

Author:	Title:	Year:	HPO Accession #: (if applicable)
Everts & Stewart	Combination Atlas Map of Middlesex County, New Jersey. Everts & Stewart, Philadelphia, Pennsylvania.	1876	
Heritage Studies	Preserving Historic Cranbury Village. Prepared for the Cranbury Township Historic Preservation Advisory Committee.	1989	
Middlesex County Clerk's Office	On file, Middlesex County Clerk's Office, New Brunswick, New Jersey.		
Nationwide Environmental Title Research (NETR)	Historic Aerial Photograph. Electronic document, <a href="https://www.historicaerials.com">https://www.historicaerials.com</a> , accessed March 2023.	1953	
Nationwide Environmental Title Research (NETR)	Historic Aerial Photograph. Electronic document, <a href="https://www.historicaerials.com">https://www.historicaerials.com</a> , accessed March 2023.	1957	
Nationwide Environmental Title Research (NETR)	Historic Aerial Photograph. Electronic document, <a href="https://www.historicaerials.com">https://www.historicaerials.com</a> , accessed March 2023.	1970	
Nationwide Environmental Title Research (NETR)	Historic Aerial Photograph. Electronic document, <a href="https://www.historicaerials.com">https://www.historicaerials.com</a> , accessed March 2023.	1979	
Nationwide Environmental Title Research (NETR)	Historic Aerial Photograph. Electronic document, <a href="https://www.historicaerials.com">https://www.historicaerials.com</a> , accessed March 2023.	1987	
Nationwide Environmental Title Research (NETR)	Historic Aerial Photograph. Electronic document, <a href="https://www.historicaerials.com">https://www.historicaerials.com</a> , accessed March 2023.	1995	
Nationwide	Historic Aerial Photograph. Electronic document, <a href="https://www.historicaerials.com">https://www.historicaerials.com</a> , accessed March 2023.	2002	

**Survey Name:** Cranbury Historic Sites Survey Phase III

**Surveyor:** Spencer Rubino

**Organization:** Richard Grubb & Associates, Inc.

☒ (Primary Contact)

**Property ID:**

**-635474467**

Page 2

Environmental Title Research (NETR) <https://www.historicaerials.com>, accessed March 2023.

Sanborn Map Company	Insurance Maps of Cranbury, Middlesex New Jersey. Sanborn Map Company. New York, New York.	1916
Sanborn Map Company	Insurance Maps of Cranbury, Middlesex New Jersey. Sanborn Map Company. New York, New York.	1933

**Additional Information:**

The building at 12A Station Road was identified in the 1980 Cranbury Historic District National Register of Historic Places nomination and evaluated as a contributing resource in the 1989 Heritage Studies inventory of the district (Walsh 1980; Heritage Studies 1989). Richard Grubb & Associates, Inc. recommends 12A Station Road as a non-contributing resource to the Cranbury Historic District due to a lack of integrity of materials, design, and workmanship.

**More Research Needed?** ☐ (checked=Yes)

---

**INTENSIVE-LEVEL USE ONLY:**

<b>Attachments Included:</b>	<input type="checkbox"/> Building	<input type="checkbox"/> Bridge
	<input type="checkbox"/> Structure	<input type="checkbox"/> Landscape
	<input type="checkbox"/> Object	<input type="checkbox"/> Industry

**Historic District ?** ☒

**District Name:** Cranbury Historic District

**Status:** Non Contributing

**Associated Archeological Site/Deposits?** ☐

(known or potential sites. If Yes, please describe briefly)

---

Conversion Problem? ☐ ConversionNote: 1202\_18\_13\_C002

Date form completed: 6/21/2023

---

**Survey Name:** Cranbury Historic Sites Survey Phase III

**Surveyor:** Spencer Rubino

**Organization:** Richard Grubb & Associates, Inc.

☒ (Primary Contact)

**Property ID:**

**-635474467**

Page 3