

PROPERTY REPORT

Property ID: -1742884929

Property Name: 38 Station Road

Ownership: Private

Address: 38 Station RD

Apartment #:

ZIP: 08512

PROPERTY LOCATION(S):

County:	Municipality:	Local Place Name:	USGS Quad:	Block:	Lot:
MIDDLESEX	Cranbury township	Cranbury	Hightstown	18	20.21

Property Photo:



Old HSI Number:

NRIS Number:

HABS/HAER Number:

Description:

38 Station Road is a two-story-tall, five-bay-wide, frame dwelling constructed circa 1985 in the New Traditional Colonial Revival style. The dwelling consists of a side-gabled main block and a one-story, side-gabled, east wing that contains an attached garage. Asphalt shingles cover the roof throughout. The roofline of the main block is accented by a dentillated frieze board. An off-center, exterior, brick chimney abuts the west elevation of the main block. The exterior of the dwelling is clad in vinyl siding. Windows are all one-over-one, vinyl-sash units. The primary (north) elevation of the main block has symmetrical fenestration with inoperable, vinyl louvered shutters flanking the windows and molded wood lintels above the first-floor windows only. The central, primary entrance is recessed and contains a paneled wood door with a glazed storm door, flanked by wood sidelights. Framing the entrance bay is a wood surround with a broken pediment and with fluted pilasters. The east and west elevations of the main block are devoid of openings. The east wing contains symmetrically placed windows flanked by inoperable, vinyl louvered shutters on the primary elevation and two vinyl roll-top garage doors on the east elevation. The rear (south) elevation is not visible from the public right-of-way.

History: 38 Station Road was constructed circa 1985 and is an example of a late twentieth-century, New Traditional Colonial-Revival style dwelling in Cranbury. The subject dwelling was likely constructed by MECCA Development corporation around 1985 (Nationwide Environmental Title Research [NETR] 1984; Middlesex County Clerk's Office 1985 Deed Book 3467:522). The dwelling first appears on a 1987 aerial photograph with its current footprint (NETR 1987). The dwelling appears to have undergone no significant changes since 1987 (NETR 1995, 2002; Google 2007).

Setting:

38 Station Road is sited on a roughly rectangular-shaped parcel (Block 18, Lot 20.21) located on the south side of Station Road in Cranbury Township, Middlesex County, New Jersey. The dwelling is oriented with its primary elevation facing north and is set back approximately 64 feet from the road. An asphalt-paved driveway extends south from Station Road to the east elevation of the dwelling's attached garage. Mature trees and shrubs are planted within close proximity to the dwelling. The subject dwelling is located in a residential neighborhood surrounded by properties generally dating from the mid-nineteenth to the late twentieth centuries.

Survey Name: Cranbury Historic Sites Survey Phase III

Surveyor: Spencer Rubino

Organization: Richard Grubb & Associates, Inc.

☒ (Primary Contact)

Property ID:

-1742884929

Page 1

Registration
and Status
Dates:

National Historic Landmark?: ☐

National Register: 9/18/1980

New Jersey Register: 8/9/1979

Determination of Eligibility: 3/25/1977

Certification of Eligibility:

SHPO Opinion:

Local Designation: 9/26/1988

Other Designation:

Other Designation Date:

☐ Eligibility Worksheet included in present survey?

☐ Is this Property an identifiable farm or former farm?

Location Map:

Site Map:

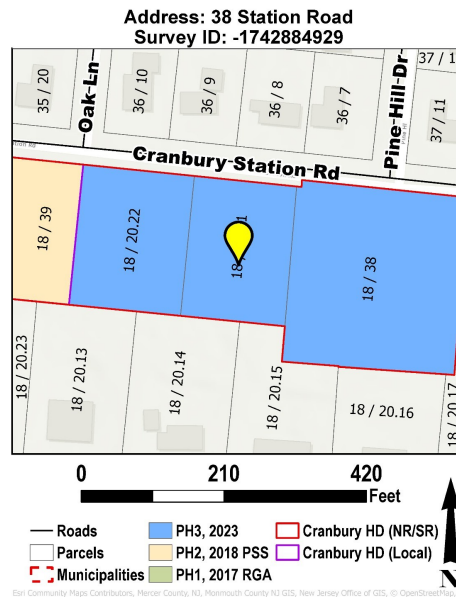

BIBLIOGRAPHY:

Author:	Title:	Year:	HPO Accession #: (if applicable)
Google	Google Street View. Electronic Document, https://www.google.com/maps/ , accessed May 2023.	2007	
Middlesex County Clerk's Office [MCCO]	On file, Middlesex County Clerk's Office, New Brunswick, New Jersey.		
Nationwide Environmental Title Research (NETR)	Historic Aerial Photograph. Electronic document, https://www.historicaerials.com , accessed May 2023.	1984	
Nationwide Environmental Title Research (NETR)	Historic Aerial Photograph. Electronic document, https://www.historicaerials.com , accessed May 2023.	1987	
Nationwide Environmental Title Research (NETR)	Historic Aerial Photograph. Electronic document, https://www.historicaerials.com , accessed May 2023.	1995	
Nationwide Environmental Title Research (NETR)	Historic Aerial Photograph. Electronic document, https://www.historicaerials.com , accessed May 2023.	2002	

Additional Information:

Richard Grubb & Associates, Inc. recommends 38 Station Road as a non-contributing resource to the Cranbury Historic District due to its date of construction.

More Research Needed? ☐ (checked=Yes)

INTENSIVE-LEVEL USE ONLY:

Attachments Included: 0 Building 0 Bridge
0 Structure 0 Landscape
0 Object 0 Industry

Historic District ? ☒

District Name: Cranbury Historic District

Survey Name: Cranbury Historic Sites Survey Phase III

Surveyor: Spencer Rubino

Organization: Richard Grubb & Associates, Inc.

Property ID:

-1742884929

Page 2

☒ (Primary Contact)

Status: Non Contributing

Associated Archeological Site/Deposits?

☐

(known or potential sites. If Yes, please describe briefly)

Conversion Problem? ☐

ConversionNote: 1202_18_20.21

Date form completed: 6/21/2023

Survey Name: Cranbury Historic Sites Survey Phase III

Surveyor: Spencer Rubino

Organization: Richard Grubb & Associates, Inc.

☒ (Primary Contact)

Property ID:

-1742884929

Page 3

PROPERTY REPORT: PHOTO CONTINUATION SHEET

Property ID: -1742884929

Property Name: 38 Station Road

Address: 38 Station RD



Photo 2



Photo 3