

PROPERTY REPORT

Property ID: 1825709576

Property Name: 5 Cranbury Neck Road

Ownership: Private

Address: 5 Cranbury Neck RD

Apartment #:

ZIP: 08512

PROPERTY LOCATION(S):

County:	Municipality:	Local Place Name:	USGS Quad:	Block:	Lot:
MIDDLESEX	Cranbury township	Cranbury	Hightstown	21	4.02

Property Photo:



Old HSI Number:

NRIS Number:

HABS/HAER Number:

Description:

5 Cranbury Neck Road is a one-and-one-half-story-tall, three-bay-wide, two-bay-deep, frame bungalow built circa 1929 in the Craftsman style. It consists of a side-gabled main block with an intersecting gable-roof enclosed porch on the primary (north) elevation, and a one-story, shed-roof wing on the rear (south) elevation. A large, gable-roof dormer interrupts both roof slopes of the main block (added circa 1973). An interior parged chimney pierces the roof of the dormer. The roof is sheathed in asphalt shingles and is accented by overhanging eaves. The exterior is clad in machined shingles. Windows are primarily three-over-one, vinyl-sash replacement units, with vinyl hopper windows in the dormer. Windows on the main block are set into wood surrounds with slightly molded lintels (likely original). The primary elevation is dominated by the enclosed porch, which contains paired, three-over-one, vinyl-sash windows and is supported by square, wood columns set on rusticated cast-stone bases (likely original). The central, primary entrance to the porch contains a glazed vinyl door, accessed by a brick stoop with metal railings. On the upper floor of the enclosed porch, there are paired, three-over-one, vinyl-sash windows set into wood surrounds similar to those seen on the main block. The east and west elevations of the main block have regular fenestration with vinyl-sash windows in the gable ends. The rear (south) elevation is not visible from the public right of way. The dwelling stands atop a parged foundation.

A circa-1929, one-story-tall, one-bay-wide, frame garage stands approximately 25 feet south of the dwelling. The garage features a front-gabled main block with a circa-1960, shed-roof addition on the rear (south) elevation. Asphalt shingles cover the roof and the exterior is clad in vinyl siding. A metal, roll-top door is centered on the primary (east) elevation of the main block and a pair of wood doors is centered on the east elevation of the rear addition.

History: 5 Cranbury Neck Road was built circa 1929 and is an example of an early twentieth-century, Craftsman-style bungalow in Cranbury. In 1927, H. William Updike purchased several large tracts of farmland on the south side of Cranbury Neck Road from the estate of James Addison Henry (Middlesex County Clerk's Office [MCCO] 1927 Deed Book 894:410). Two years later, Updike sold a small parcel, encompassing the subject property, to Charles V.D. Symmes (MCCO 1929 Deed Book 943:369). It is likely that the subject dwelling was constructed by Symmes shortly after his 1929 purchase, and it first appears on a 1930 aerial photograph (New Jersey Department of Environmental Protection 1930). Symmes is listed in the 1930 federal census as a farmer residing on Station Road, northeast of the subject dwelling, indicating that the subject dwelling was likely rented to tenants during Symmes' ownership (United States Bureau of the Census 1930). A 1933 Sanborn map of Cranbury depicts the subject dwelling in its current footprint with a one-story porch

Survey Name: Cranbury Historic Sites Survey Phase III

Surveyor: Matthew Goldberg

Organization: Richard Grubb & Associates, Inc.

☒ (Primary Contact)

Property ID:

1825709576

Page 1

across its primary elevation, accompanied by a frame garage to the south (Sanborn Map Company 1933). Around 1960, a shed-roof addition was constructed on the rear elevation of the garage (Nationwide Environmental Title [NETR] 1957, 1963). A large dormer was constructed on the roof of the dwelling around 1973 (NETR 1979, 1987). At some point in the mid-to-late twentieth century, the porch on the primary elevation of the dwelling was enclosed and windows on the main block of the dwelling were replaced with the current vinyl-sash units. Around 2017 the porch-front windows were changed from one-over-one vinyl sash units to the extant three-over-one units (Google 2016, 2018).

Setting:

5 Cranbury Neck Road is sited on a rectangular parcel (Block 21, Lot 41.02) located on the south side of Cranbury Neck Road in Cranbury Township, Middlesex County, New Jersey. The dwelling is oriented with its primary elevation facing north and is set back approximately 20 feet from the road. An asphalt driveway extends along the east border of the property. Gravel paths lead from the driveway to the main entry and a rear entry. Mature trees and shrubs are planted within close proximity to the dwelling. The subject property is located in a residential neighborhood surrounded by properties dating from the mid-nineteenth to the early twentieth centuries.

Registration and Status Dates:

National Historic Landmark?: ☐

National Register: 9/18/1980

New Jersey Register: 8/9/1979

Determination of Eligibility: 3/25/1977

Certification of Eligibility:

SHPO Opinion:

Local Designation: 9/26/1988

Other Designation:

Other Designation Date:

☐ Eligibility Worksheet included in present survey?

☐ Is this Property an identifiable farm or former farm?

Location Map:

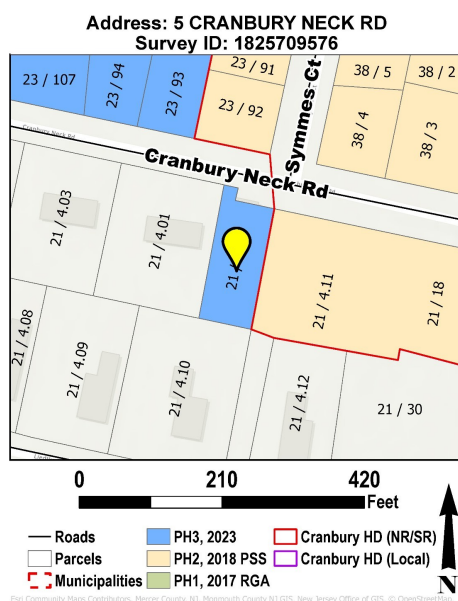

Site Map:

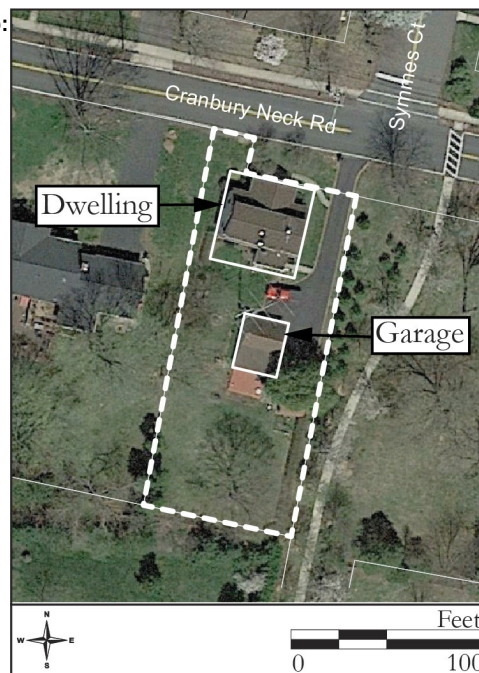

BIBLIOGRAPHY:

Author:	Title:	Year:	HPO Accession #: (if applicable)
Google	Google Street View. Electronic document, www.maps.google.com, accessed June 2023.	2016	
Google	Google Street View. Electronic document, www.maps.google.com, accessed June 2023.	2018	
Middlesex County Clerk's Office (MCCO)	On file, Middlesex County Clerk's Office, New Brunswick, New Jersey.		
Nationwide Environmental Title Research (NETR)	Historic Aerial Photograph. Electronic Document, http://www.historicaerials.com, accessed April 2023.	1957	
Nationwide Environmental Title Research (NETR)	Historic Aerial Photograph. Electronic Document, http://www.historicaerials.com, accessed April 2023.	1963	
Nationwide Environmental Title Research (NETR)	Historic Aerial Photograph. Electronic Document, http://www.historicaerials.com, accessed April 2023.	1979	
Nationwide Environmental Title Research (NETR)	Historic Aerial Photograph. Electronic Document, http://www.historicaerials.com, accessed April 2023.	1987	

Survey Name: Cranbury Historic Sites Survey Phase III

Surveyor: Matthew Goldberg

Organization: Richard Grubb & Associates, Inc.

☒ (Primary Contact)

Property ID:

1825709576

Page 2

Research (NETR)

New Jersey Department of Environmental Protection	NJ-GeoWeb. Electronic Document, https://www.nj.gov/dep/gis/geoweb splash.htm , accessed April 2023.	1930
Sanborn Map Company	Insurance Maps of Cranbury, Middlesex County, New Jersey. Sanborn Map Company, New York, New York.	1933
United States Bureau of the Census	Population Schedule, Cranbury Township, Middlesex County, New Jersey.	1930

Additional Information:

Richard Grubb & Associates, Inc. recommends 5 Cranbury Neck Road as a non-contributing resource to the Cranbury Historic District due to a lack of integrity of materials, design, and workmanship. The addition of a larger dormer to the roof distorts the building's original massing.

More Research Needed? ☐ (checked=Yes)

INTENSIVE-LEVEL USE ONLY:

Attachments Included:	0 Building	0 Bridge
	0 Structure	0 Landscape
	0 Object	0 Industry

Historic District ? ☒

District Name: Cranbury Historic District

Status: Contributing

Associated Archeological Site/Deposits? ☐

(known or potential sites. If Yes, please describe briefly)

Conversion Problem? ☐ ConversionNote: 1202_21_4.02

Date form completed: 6/21/2023

Survey Name: Cranbury Historic Sites Survey Phase III

Surveyor: Matthew Goldberg

Organization: Richard Grubb & Associates, Inc.

☒ (Primary Contact)

Property ID:

1825709576

Page 3

PROPERTY REPORT: PHOTO CONTINUATION SHEET

Property ID: 1825709576

Property Name: 5 Cranbury Neck Road

Address: 5 Cranbury Neck RD



Photo 2



Photo 3