

PROPERTY REPORT

Property ID: -381209426

Property Name: 12 Cranbury Neck Road

Ownership: Private

Address: 12 Cranbury Neck RD

Apartment #:

ZIP: 08512

PROPERTY LOCATION(S):

County:	Municipality:	Local Place Name:	USGS Quad:	Block:	Lot:
MIDDLESEX	Cranbury township	Cranbury	Hightstown	23	107

Property Photo:



Old HSI Number:

NRIS Number:

HABS/HAER Number:

Description:

12 Cranbury Neck Road is a one-and-one-half-story-tall, four-bay-wide, three-bay-deep, frame dwelling built circa 1933 in the Tudor Revival style. The dwelling consists of a side-gabled main block and an off-center, front-gabled wing with a flared eave that forms a covered porch. Extending from the west elevation is a one-story-tall side-gabled porch. An interior parged chimney rises above the roof junction of the main block and porch. The roof is sheathed in asphalt shingles. The exterior of the dwelling is covered in stucco (historic, likely original). Windows are primarily paired, six-over-six, wood-sash units, set within wood surrounds (historic, likely original) with aluminum storm windows. A tripartite vinyl window is featured in the west bay of the primary elevation of the main block and another is located on the front-gabled wing. The front-gabled wing also contains a wood louvered vent in the gable end. Situated in the second westernmost bay of the main block, beneath the porch formed by the flared eave of the front-gabled wing, the primary entrance features a wood French door (possibly historic) and is accessed by a concrete stoop. The east elevation of the main block contains a central, secondary entrance with a wood paneled door and a metal storm door, sheltered by a gabled portico with wood posts. The rear (north) elevation is not visible from the public right of way. The dwelling stands atop a parged foundation.

Character-defining elements of the dwelling include its massing, wood-sash windows, and front-gabled wing with a flared eave.

History: 12 Cranbury Neck Road, constructed circa 1933, is an example of an early twentieth-century, Tudor Revival-style dwelling in Cranbury. In 1927, H. William Updike purchased several large tracts of farmland on the south side of Cranbury Neck Road from the estate of James Addison Henry (Middlesex County Clerk's Office [MCCO] 1927 Deed Book 894:410). In 1933, Ruth Updike purchased the property and likely constructed the subject dwelling shortly thereafter with her husband Alvin (Middlesex County Clerk's Office [MCCO] 1933 Deed Book 1046:282). The dwelling first appears on a 1933 Sanborn map of Cranbury and is depicted with its current footprint, consisting of a side-gabled main block, a front-gabled wing, and a porch on the west elevation (Sanborn Map Company 1933). By 1940, the subject dwelling was one of six dwellings standing along the north side of Cranbury Neck Road (Nationwide Environmental Title [NETR] 1940). At this time, Ruth and Alvin Updike, a farmer, lived at the subject property with their three daughters (United States Bureau of the Census 1940). At some point during the mid-to-late twentieth century, the extant tripartite vinyl windows were installed. According to aerial imagery, the dwelling appears to have undergone little to no major alterations in the decades since its construction (NETR 1957, 1969, 1987).

Setting:

Survey Name: Cranbury Historic Sites Survey Phase III

Surveyor: Matthew Goldberg

Organization: Richard Grubb & Associates, Inc.

☒ (Primary Contact)

Property ID:

-381209426

Page 1

12 Cranbury Neck Road is sited on an irregularly shaped parcel (Block 23, Lot 107) located on the north side of Cranbury Neck Road in Cranbury Township, Middlesex County, New Jersey. The dwelling is oriented with its primary elevation facing south and is set back approximately 40 feet from the road. A gravel driveway encircles the dwelling. A concrete sidewalk lines the south border of the property. Mature trees and shrubs are planted within close proximity to the dwelling. The subject property is located in a residential neighborhood surrounded by properties dating from the mid-nineteenth to the early twentieth centuries.

**Registration
and Status
Dates:**

National Historic Landmark?: ☐

National Register: 9/18/1980

New Jersey Register: 8/9/1979

Determination of Eligibility: 3/25/1977

Certification of Eligibility:

SHPO Opinion:

Local Designation: 9/26/1988

Other Designation:

Other Designation Date:

☐ **Eligibility Worksheet included in present survey?**

☐ **Is this Property an identifiable farm or former farm?**

Location Map:

Site Map:

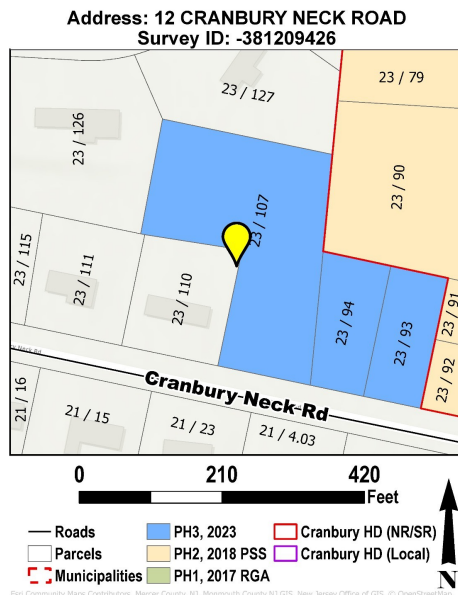

BIBLIOGRAPHY:

Author:	Title:	Year:	HPO Accession #: (if applicable)
Middlesex County Clerk's Office	On file, Middlesex County Clerk's Office, New Brunswick, New Jersey.		
Nationwide Environmental Title Research (NETR)	Historic Aerial Photograph. Electronic Document, http://www.historicaerials.com , accessed April 2023.	1940	
Nationwide Environmental Title Research (NETR)	Historic Aerial Photograph. Electronic Document, http://www.historicaerials.com , accessed April 2023.	1957	
Nationwide Environmental Title Research (NETR)	Historic Aerial Photograph. Electronic Document, http://www.historicaerials.com , accessed April 2023.	1969	
Nationwide Environmental Title Research (NETR)	Historic Aerial Photograph. Electronic Document, http://www.historicaerials.com , accessed April 2023.	1987	
Sanborn Map Company	Insurance Maps of Cranbury, Middlesex County, New Jersey. Sanborn Map Company, New York, New York.	1933	
United States Bureau of the Census	Population Schedule, Cranbury Township, Middlesex County, New Jersey.	1940	

Additional Information:

Richard Grubb & Associates, Inc. recommends 12 Cranbury Neck Road as a contributing resource to the Cranbury Historic District due to its date of construction and design. The dwelling retains sufficient integrity of materials, design, workmanship, setting, location, feeling, and association to convey the significance of the historic district.

More Research Needed? ☐ (checked=Yes)

Survey Name: Cranbury Historic Sites Survey Phase III

Surveyor: Matthew Goldberg

Organization: Richard Grubb & Associates, Inc.

☒ (Primary Contact)

Property ID:

-381209426

Page 2

INTENSIVE-LEVEL USE ONLY:

Attachments Included:

0 Building
0 Structure
0 Object

0 Bridge
0 Landscape
0 Industry

Historic District ? ☒

District Name: Cranbury Historic District

Status: Contributing

Associated Archeological Site/Deposits? ☐

(known or potential sites. If Yes, please describe briefly)

Conversion Problem? ☐

ConversionNote: 1202_23_107

Date form completed: 6/21/2023

Survey Name: Cranbury Historic Sites Survey Phase III

Surveyor: Matthew Goldberg

Organization: Richard Grubb & Associates, Inc.

☒ (Primary Contact)

Property ID:

-381209426

Page 3

PROPERTY REPORT: PHOTO CONTINUATION SHEET

Property ID: -381209426

Property Name: 12 Cranbury Neck Road

Address: 12 Cranbury Neck RD



Photo 2



Photo 3