

PROPERTY REPORT

Property ID: **-1004463450**

Property Name: 21 A-B - 23 A-B Park Place West **Ownership:** Private
Address: 21-23 Park PL W **Apartment #:** A-B **ZIP:** 08512

PROPERTY LOCATION(S):

County:	Municipality:	Local Place Name:	USGS Quad:	Block:	Lot:
MIDDLESEX	Cranbury township	Cranbury	Cranbury	23	48

Property Photo:



Old HSI Number:

NRIS Number:

HABS/HAER Number:

Description:

21 A-B Park Place West is a two-and-a-half-story tall, two-bay wide, two-bay deep, frame private dwelling constructed circa 1950. The dwelling consists of a rectangular main block with a one-story shed roof addition extending to the east. The side-gabled roof is sheathed with wood shingles. The exterior of the dwelling is clad in wood clapboard siding. An exterior chimney covered with stucco pierces the roof on the west elevation. Windows on the front (south) elevation and at the second floor of the east elevation are six-over-six, double-hung wood windows with aluminum storm windows. Windows on other elevations are one-over-one, double hung vinyl replacement windows. A louvered window sits in the east gable end. On the west elevation, a faux barn door is located between two one-over-one, double hung vinyl replacement windows. The main entrance, located in the southwest corner of the building, is a six-panel wood door with an aluminum exterior storm door. A secondary entrance is located in the southeast corner of the east shed roof addition. A one-story frame shed is located north of the dwelling.

23 A-B Park Place West is a two-unit vernacular building constructed circa 1950, consisting of a two-story, three-bay main block and a one-story, four-bay addition with a shed roof. The front-gabled roof of the main block is clad with asphalt shingles. The exterior of the dwelling is clad in vinyl siding. An interior, capped brick chimney pierces the roof at the north gable end of the main block. Windows are one-over-one, double hung vinyl replacement windows with two large vinyl picture windows on the front (south) elevation of the main block. A louvered window punctures the south gable end at the attic story. Doors providing access to both residences are six-panel modern

Survey Name: Cranbury CLG Survey 2017

Surveyor: Kristen Herrick

Organization: RGA, Inc.

(Primary Contact)

Property ID:

-1004463450

Page 1

replacement doors. Access is gained to the shed roof addition via a three-step concrete stoop with a metal railing

Setting:

21 A-B and 23 A-B Park Place West are sited on a rectangular parcel (Block 23, Lot 48) located on the north side of Park Place West in Cranbury Township, Middlesex County, New Jersey. Both dwellings are oriented with primary elevations facing south. 21 Park Place West is set back approximately 10 feet from the road, while 23 Park Place West is set back approximately 40 feet from the road. 23 Park Place West is situated northwest of 21 Park Place West. A concrete sidewalk spans the south side of the parcel. The southwest corner of the parcel is occupied by a paved parking lot. The property is lightly wooded. A one-story, frame shed is located east of 23 Park Place West. 21 and 23 Park Place West are located in a mixed residential and commercial neighborhood alongside other residential and commercial properties dating from the mid-nineteenth to the early twentieth century.

Registration and Status Dates:

National Historic Landmark?:
National Register: 9/18/1980
New Jersey Register: 8/9/1979
Determination of Eligibility: 3/25/1977
Certification of Eligibility:

SHPO Opinion:
Local Designation: 9/26/1988
Other Designation:
Other Designation Date:

Eligibility Worksheet included in present survey? Is this Property an identifiable farm or former farm?

Location Map:

Site Map:

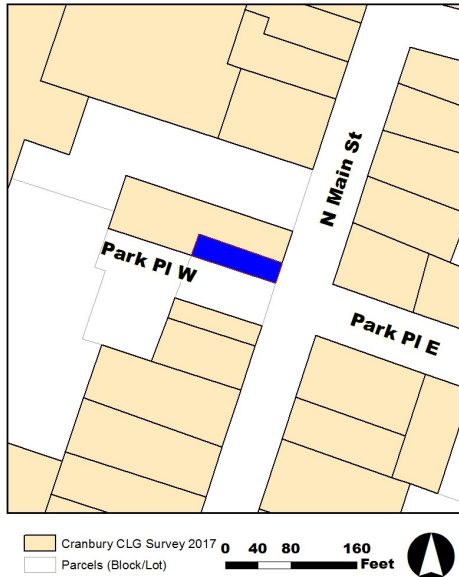

BIBLIOGRAPHY:

Author:	Title:	Year:	HPO Accession #:	(if applicable)
Walsh, Ruth	National Register of Historic Places Nomination for the Cranbury Historic District, Cranbury Township, Middlesex County, New Jersey	1979		
Heritage Studies	Preserving Historic Cranbury Village	1989		

Additional Information:

The 1989 Heritage Studies survey identified 21 A-B and 23 A-B Park Place West but did not assign resource classifications to either building. A review of historic aerial photographs shows that the subject buildings were constructed circa 1950. Therefore, RGA recommends 21 A-B and 23 A-B Park Place West as non-contributing buildings to the Cranbury Historic District due to their dates of construction.

More Research Needed? (checked=Yes)

Survey Name: Cranbury CLG Survey 2017

Surveyor: Kristen Herrick

Organization: RGA, Inc.

Property ID:

Page 2

(Primary Contact)

-1004463450

INTENSIVE-LEVEL USE ONLY:

Attachments Included: 0 Building 0 Bridge
 0 Structure 0 Landscape
 0 Object 0 Industry

Historic District ?

District Name: Cranbury Historic District

Status: Non Contributing

Associated Archeological Site/Deposits?

(known or potential sites. If Yes, please describe briefly)

Conversion Problem? ConversionNote: 43

Date form completed: 6/26/2017

Survey Name: Cranbury CLG Survey 2017

Surveyor: Kristen Herrick

Organization: RGA, Inc.

(Primary Contact)

Property ID:

-1004463450

Page 3