

## PROPERTY REPORT

Property ID: 1890525772

**Property Name:** 55 North Main Street  
**Address:** 55 N Main ST

**Ownership:** Private  
**Apartment #:** **ZIP:** 08512

### PROPERTY LOCATION(S):

County:	Municipality:	Local Place Name:	USGS Quad:	Block:	Lot:
MIDDLESEX	Cranbury township	Cranbury	Hightstown	23	50.01

### Property Photo:



**Old HSI Number:**

**NRIS Number:**

**HABS/HAER Number:**

### Description:

55 North Main Street is a three-story tall, five-bay wide, four-bay deep mixed residential and commercial building constructed circa 1869 in a vernacular Greek Revival style. The first floor functions as a storefront while the upper floors are subdivided into residential apartments. The building consists of a rectangular main block with two one-story frame additions to the northwest. The front-gabled roof is sheathed with asphalt shingles. The front gable is accentuated by a return cornice supported with wood brackets on each side. The exterior of the building is clad in aluminum siding with pressed aluminum panels on the first floor. Windows on the upper floors are two-over-two, double-hung, potentially original wood-sash windows with louvered shutters. The first floor storefront is pierced by large replacement, canted picture windows. The two entrances are replacement doors with nine inset lights above a crossbuck. The north entrance is accessed by a concrete stoop, while the south entrance is accessed by a concrete ramp with a metal railing. The northeast elevation is clad in wood clapboard siding on the first floor and aluminum siding on the upper floors. Two-over-two, double-hung, potentially original wood-sash windows perforate the elevation on the first and second floors. The third floor is distinguished by a row of paired one-over-one, double-hung, potentially original wood-sash arch windows. The rear elevation, clad in aluminum siding, features a return cornice in the gable end, two-over-two, double-hung, potentially original wood-sash windows on the second floor, and one-over-one, vinyl-sash replacement windows on the third floor. The first floor of the rear elevation is obscured by the two one-story additions, one with a shed roof and one with a front gable roof. The shed roof addition is clad in wood clapboard siding and features a fixed wood window with six inset lights, a single replacement screen door, and a brick exterior chimney on the rear. The front gable addition, also clad in wood clapboard siding, features

**Survey Name:** Cranbury CLG Survey 2017

**Surveyor:** Kristen Herrick

**Organization:** RGA, Inc.

☒ (Primary Contact)

**Property ID:**

1890525772

Page 1

two two-over-two, double-hung, wood-sash windows and a fixed wood window beneath the gable peak. The southwest elevation of the subject building is not visible from the public right of way.

**History:** 55 North Main Street was constructed circa 1869 by Samuel L. Groves. The building served as a pharmacy until 1996 under several owners. Today, the building hosts David Wells Antiques (Cranbury Historical and Preservation Society n.d.). The subject building first appears cartographically on the 1872 Beers atlas as owned by "S. Groves," referring to Samuel L. Groves. The 1872 Beers atlas shows the front gable addition, which was likely constructed circa 1871. On the 1876 Everts and Stewart map, the subject building is labelled as a drugstore. The 1916 Sanborn map indicates that the subject building was occupied by a drugstore in the northern half of the building and a grocery store in the southern half of the building. The shed roof addition first appears on the 1916 Sanborn map, along with two frame outbuildings to the rear of the subject building. The 1933 Sanborn map indicates no changes to the subject building. The two frame outbuildings were demolished by 1963 according to historic aerials.

**Setting:**

55 North Main Street is sited on a rectangular parcel (Block 23, Lot 50.01) located on the west side of North Main Street in Cranbury Township, Middlesex County, New Jersey. The building is oriented with its primary elevation facing southeast and is set back approximately 10 feet from North Main Street. A concrete sidewalk spans the east side of the parcel. Trees are planted along the curb between the building and North Main Street. A paved parking lot is located west of the building. 55 North Main Street is located in a mixed residential and commercial neighborhood surrounded by commercial and residential properties dating from the mid-nineteenth to the early twentieth centuries.

**Registration  
and Status  
Dates:**

**National Historic Landmark?:** ☐

**National Register:** 9/18/1980

**New Jersey Register:** 8/9/1979

**Determination of Eligibility:** 3/25/1977

**Certification of Eligibility:**

**SHPO Opinion:**

**Local Designation:** 9/26/1988

**Other Designation:**

**Other Designation Date:**

☐ **Eligibility Worksheet included in present survey?**

☐ **Is this Property an identifiable farm or former farm?**

**Location Map:**

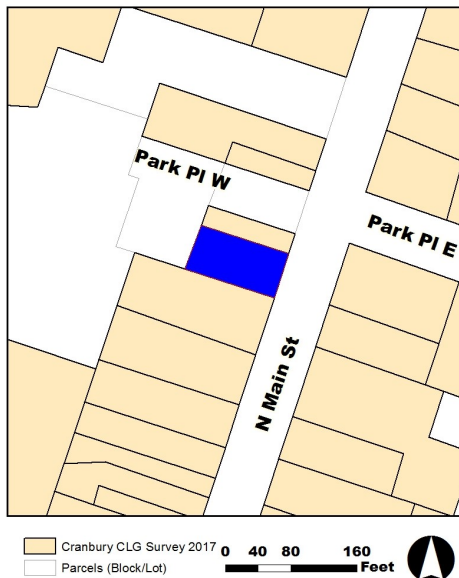

**Site Map:**

**BIBLIOGRAPHY:**

Author:	Title:	Year:	HPO Accession #:	(if applicable)
Walsh, Ruth	National Register of Historic Places Nomination for the Cranbury Historic District, Cranbury Township, Middlesex County, New Jersey	1979		

**Survey Name:** Cranbury CLG Survey 2017

**Surveyor:** Kristen Herrick

**Organization:** RGA, Inc.

☒ (Primary Contact)

**Property ID:**

**1890525772**

Page 2

Heritage Studies                      Preserving Historic Cranbury Village                      1989  
Cranbury Historical and              Property File, 55 North Main Street  
Preservation Society

**Additional Information:**

The 1989 Heritage Studies survey found that 55 North Main Street is a contributing resource to the Cranbury Historic District. RGA concurs with the previous evaluation and recommends 55 North Main Street as a contributing resource due to its date of construction and significance as one of the earliest surviving commercial properties on North Main Street.

**More Research Needed?**      ☐ (checked=Yes)

---

**INTENSIVE-LEVEL USE ONLY:**

**Attachments Included:**              0 Building                      0 Bridge  
                                                 0 Structure                      0 Landscape  
                                                 0 Object                        0 Industry

**Historic District ?**      ☒

**District Name:** Cranbury Historic District

**Status:** Contributing

**Associated Archeological Site/Deposits?**      ☐

(known or potential sites. If Yes, please describe briefly)

---

Conversion Problem?      ☐      ConversionNote:      69

*Date form completed:*              7/25/2017

---

**Survey Name:** Cranbury CLG Survey 2017

**Surveyor:** Kristen Herrick

**Organization:** RGA, Inc.

☒ (Primary Contact)

**Property ID:**

**1890525772**

Page 3