

PROPERTY REPORT

Property ID: 80057038

Property Name: John Nesbit House
Address: 41 N Main ST

Ownership: Private
Apartment #: **ZIP:** 08512

PROPERTY LOCATION(S):

County:	Municipality:	Local Place Name:	USGS Quad:	Block:	Lot:
MIDDLESEX	Cranbury township	Cranbury	Hightstown	23	53

Property Photo:



Old HSI Number:

NRIS Number:

HABS/HAER Number:

Description:

The John Nesbit House at 41 North Main Street is a two-story tall, four-bay wide, two-bay deep, frame private residence constructed circa 1804 in a vernacular style. The dwelling, which sits on a brick foundation, consists of a rectangular side-gabled main block; a two-story rear ell; and a two-story side-gabled wing adjoining the ell to the northeast. The roof is sheathed with slate shingles and has molded wood eaves. An interior brick chimney is located at the southwest gable end of the main block. The exterior of the dwelling is clad in wood clapboard siding on all elevations. The front elevation has a two-story, semi-hexagonal projecting bay with two-over-two, double-hung, wood-sash windows, molded lintels, and louvered shutters. Windows on the first floor are two-over-one, double-hung, replacement wood-sash windows with aluminum screen windows, molded lintels, and louvered shutters. The central entrance is a double-leaf, single-light wood door with molded hexagonal panels and a rectangular transom within a molded wood surround. A one-story porch with turned wood posts and a low railing with turned wood balusters shelters the north bays on the first floor. The porch terminates at a one-story, one-bay addition at the northeast corner of the dwelling; this addition is part of an earlier wraparound porch, now partially enclosed. The southwest elevation of the main block has two four-light fixed vinyl replacement windows in the gable end; a two-over-two, double-hung, wood-sash window on the second floor; and a two-over-one, double-hung, wood-sash window on the first floor. The rear ell has two-over-two, double-hung, wood-sash windows and a one-story, shed roof porch sheltering the first floor. The northeast elevation of the main block has two four-light fixed vinyl replacement windows in the gable end and a two-over-two, double-hung, wood-sash window on the second floor. The

Survey Name: Cranbury CLG Survey 2017

Surveyor: Kristen Herrick

Organization: RGA, Inc.

☒ (Primary Contact)

Property ID:

80057038

Page 1

first floor of the one-story addition has two-over-one, double-hung, wood-sash windows with louvered shutters on either side of a single leaf door with a single light above a rectangular panel. This secondary entrance is sheltered by a one-story entry porch with cast iron posts and a concrete stoop with three brick steps. The two-story rear wing has a two-story, semi-hexagonal projecting bay in the east bay. All windows, including those on the projecting bay, are two-over-one, double-hung, wood-sash. Character-defining elements of the dwelling include the semi-hexagonal projecting bays and louvered shutters. A two-story, side-gabled frame barn (constructed circa 1910) stands at the rear of the property.

History: The John Nesbit House at 41 North Main Street first appears cartographically on the 1861 Walling map of Cranbury Township, owned by "J. Vanderveer." Vanderveer owned the subject dwelling through the end of the nineteenth century according to the 1872 Beers atlas and the 1876 Everts and Stewart map. The 1916 Sanborn map shows the subject dwelling as a two-story frame dwelling with a semi-hexagonal projecting bay, a two-story rear ell, a one-story wraparound front porch, and a one-story porch on the southwest elevation. Three frame outbuildings stood on the property; only one of these outbuildings survives today. The 1933 Sanborn map shows no changes to the property except for the removal of one of the frame outbuildings. Historic aerial photographs show that the two-story wing adjoining the rear ell was constructed circa 2001.

Setting:

The John Nesbit House at 41 North Main Street is sited on a rectangular parcel (Block 23, Lot 53) located on the west side of North Main Street in Cranbury Township, Middlesex County, New Jersey. The dwelling is oriented with its primary elevation facing southeast and is set back approximately 10 feet from North Main Street. A concrete sidewalk, which runs along North Main Street, spans the east side of the parcel. A concrete driveway leads west past the northwest elevation of the dwelling to a gravel driveway. A two-story frame barn is located to the rear (west) of the dwelling. Shrubs about the front (northeast) elevation of the dwelling. 41 North Main Street is located in a mixed residential and commercial neighborhood surrounded by properties dating from the mid-nineteenth to the early twentieth century.

**Registration
and Status
Dates:**

National Historic Landmark?: ☐

National Register: 9/18/1980

New Jersey Register: 8/9/1979

Determination of Eligibility: 3/25/1977

Certification of Eligibility:

SHPO Opinion:

Local Designation: 9/26/1988

Other Designation:

Other Designation Date:

☐ **Eligibility Worksheet included in present survey?**

☐ **Is this Property an identifiable farm or former farm?**

Location Map:

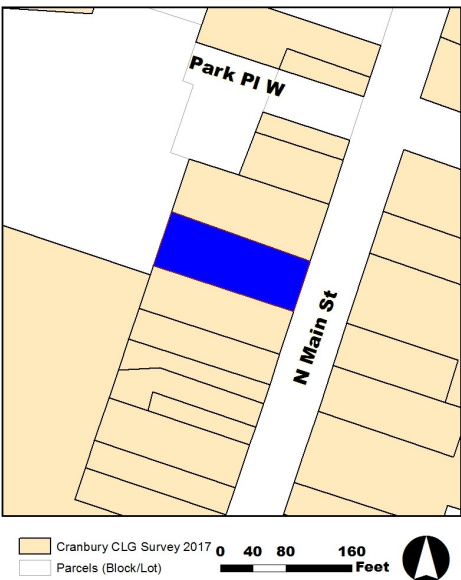

Site Map:



BIBLIOGRAPHY:

Author:

Title:

Year:

HPO Accession #: (if applicable)

Cranbury Historical and Property File, 41 North Main Street

Survey Name: Cranbury CLG Survey 2017

Surveyor: Kristen Herrick

Organization: RGA, Inc.

☒ (Primary Contact)

Property ID:

80057038

Walsh, Ruth	National Register of Historic Places Nomination for the Cranbury Historic District, Cranbury Township, Middlesex County, New Jersey	1979
Heritage Studies	Preserving Historic Cranbury Village	1989

The 1989 Heritage Studies survey identified 41 North Main Street as a contributing resource to the Cranbury Historic District. RGA concurs with the previous evaluation and recommends 41 North Main Street as a contributing resource due to its date of construction and design.

More Research Needed? ☐ (checked=Yes)

Attachments Included:

0 Building	0 Bridge
0 Structure	0 Landscape
0 Object	0 Industry

Historic District ? ☒

District Name: Cranbury Historic District

Status: Contributing

Associated Archeological Site/Deposits? ☐

(known or potential sites. If Yes, please describe briefly)

Conversion Problem? ☐ ConversionNote: 99

Date form completed: 6/26/2017

Survey Name: Cranbury CLG Survey 2017

Surveyor: Kristen Herrick

Organization: RGA, Inc.

☒ (Primary Contact)

Property ID:

80057038