

PROPERTY REPORT

Property ID: -1298020107

Property Name: George Morris House

Ownership: Private

Address: 31 N Main ST

Apartment #:

ZIP: 08512

PROPERTY LOCATION(S):

County:	Municipality:	Local Place Name:	USGS Quad:	Block:	Lot:
MIDDLESEX	Cranbury township	Cranbury		23	58

Property Photo:



Old HSI Number:

NRIS Number:

HABS/HAER Number:

Description:

The George Morris House at 31 North Main Street is a two-story tall, two-bay wide, two-bay deep, frame private residence constructed in 1834. The dwelling consists of a rectangular, side-gabled main block with a two-story, two-bay addition and a one-story, one-bay shed roof addition to the rear (both constructed by 1916). The roof is sheathed with asphalt shingles. An interior brick chimney pierces the roof on the southwest bent of the two-story rear addition. The roof is sheathed with wood shingles with a return cornice at the gable ends of the main block. The slightly overhanging eaves are supported by brackets. The exterior of the dwelling is clad in Hardi-Plank siding. A wood frieze runs beneath the eaves on the front elevation. The two windows on the second floor of the front elevation are six-over-six, vinyl-sash replacement windows with louvered shutters. A square projecting bay window, with six-over-six vinyl-sash windows and a hipped standing steam copper cap, sits in the north bay on the first floor. The entrance, located beside the bay window, is a single four-panel wood door with a vinyl storm door. The entrance is sheltered by a one-story entry porch with a hipped standing steam copper roof and unfluted Doric columns. Access is gained via a concrete stoop with rowlock brick trimmers. The northwest elevation features six-over-six, vinyl-sash replacement windows with louvered shutters on the second floor and paneled shutters on the second floor. The southeast and rear elevations are not visible from the public right-of-way. Character-defining elements of the dwelling include the bracketed cornice and one-story entry porch.

History: The subject dwelling was constructed in 1834 by George Morris. Between 1897 and 1910, the George Morris House served as the

Survey Name: Cranbury CLG Survey 2017

Surveyor: Kristen Herrick

Organization: RGA, Inc.

☒ (Primary Contact)

Property ID:

-1298020107

Page 1

Cranbury Post Office. Postmaster Harry Moore also lived and operated a watch and jewelry shop in the subject building (Chambers 2012:98). The subject dwelling first appears cartographically on the 1861 Walling map of Cranbury Township, owned by "R. Morris." On the 1872 Beers atlas, the subject dwelling appears on a lot adjoining the property of John Thorp. By the 1876 Everts and Stewart map, the subject dwelling is owned by Jacob Prince. The subject dwelling appears on the 1916 Sanborn map as a two-story frame dwelling with a one-story, full-length front porch and a two-story addition and a one-story addition to the rear. Several frame outbuildings were also located to the rear of the subject dwelling. The 1933 Sanborn map shows that the one-story porch was removed and the outbuildings were demolished except for a one-story frame shed, demolished circa 1980.

Setting:

The George Morris House at 31 North Main Street is sited on a rectangular parcel (Block 23, Lot 58) located on the west side of North Main Street in Cranbury Township, Middlesex County, New Jersey. The dwelling is oriented with its primary elevation facing southeast and is set back approximately 10 feet from North Main Street. The sidewalk directly in front of the dwelling is paved with bricks. A concrete sidewalk leads west from North Main Street past the dwelling's northwest elevation to the backyard, planted in grass. A one-story, frame shed is located to the rear (west) of the dwelling. 31 North Main Street is located in a mixed residential and commercial neighborhood surrounded by properties dating from the mid-nineteenth to the early twentieth century.

Registration and Status Dates:

National Historic Landmark?: ☐

National Register: 9/18/1980

New Jersey Register: 8/9/1979

Determination of Eligibility: 3/25/1977

Certification of Eligibility:

SHPO Opinion:

Local Designation: 9/26/1988

Other Designation:

Other Designation Date:

☐ **Eligibility Worksheet included in present survey?**

☐ **Is this Property an identifiable farm or former farm?**

Location Map:

Site Map:

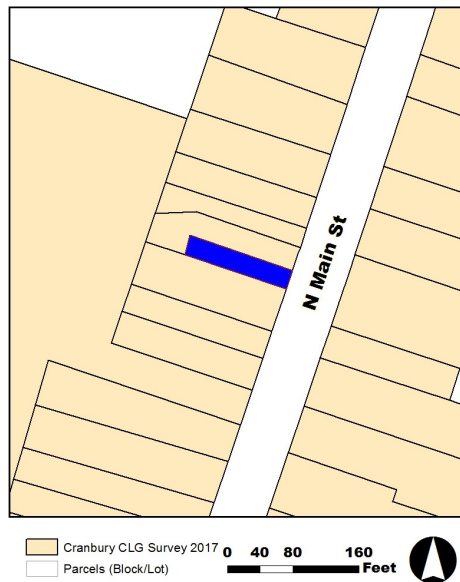

BIBLIOGRAPHY:

Author:	Title:	Year:	HPO Accession #: (if applicable)
Chambers, John Whiteclay II	Cranbury: A New Jersey Town from the Colonial Era to the Present	2012	
Walsh, Ruth	National Register of Historic Places Nomination for the Cranbury Historic District, Cranbury Township, Middlesex County, New Jersey	1979	
Heritage Studies	Preserving Historic Cranbury Village	1989	

Survey Name: Cranbury CLG Survey 2017

Surveyor: Kristen Herrick

Organization: RGA, Inc.

☒ (Primary Contact)

Property ID:

-1298020107

Page 2

Additional Information:

The 1989 Heritage Studies survey identified the George Morris House at 31 North Main Street as a contributing resource to the Cranbury Historic District. RGA concurs with the previous evaluation and recommends the George Morris House at 31 North Main Street due to its date of construction.

More Research Needed? ☐ (checked=Yes)

INTENSIVE-LEVEL USE ONLY:

Attachments Included:

<input type="checkbox"/> Building	<input type="checkbox"/> Bridge
<input type="checkbox"/> Structure	<input type="checkbox"/> Landscape
<input type="checkbox"/> Object	<input type="checkbox"/> Industry

Historic District ? ☒

District Name: Cranbury Historic District

Status: Contributing

Associated Archeological Site/Deposits? ☐

(known or potential sites. If Yes, please describe briefly)

Conversion Problem? ☐ **ConversionNote:** 46

Date form completed: 6/26/2017

Survey Name: Cranbury CLG Survey 2017

Surveyor: Kristen Herrick

Organization: RGA, Inc.

☒ (Primary Contact)

Property ID:

-1298020107

Page 3