

PROPERTY REPORT

Property ID: 1744379024

Property Name: Old Cranbury School
Address: 23 N Main ST

Ownership: Public
Apartment #: **ZIP:** 08512

PROPERTY LOCATION(S):

County:	Municipality:	Local Place Name:	USGS Quad:	Block:	Lot:
MIDDLESEX	Cranbury township	Cranbury	Hightstown	23	63.011

Property Photo:



Old HSI Number:

NRIS Number:

HABS/HAER Number:

Description:

Old Cranbury School at 23 North Main Street has undergone little to no alterations since Richard Grubb & Associates, Inc. surveyed it in 2017.

Setting:

No changes from the 2017 survey.

**Registration
and Status
Dates:**

National Historic Landmark?: ☐

National Register: 9/18/1980

New Jersey Register: 8/9/1979

Determination of Eligibility: 3/25/1977

Certification of Eligibility:

SHPO Opinion:

Local Designation: 9/26/1988

Other Designation: Individual NRHP Listing

Other Designation Date: 6/21/1971

☒ **Eligibility Worksheet included in present survey?**

☐ **Is this Property an identifiable farm or former farm?**

Survey Name: Cranbury Historic Sites Survey Phase III

Surveyor: Kristen Herrick

Organization: Richard Grubb & Associates, Inc.

☐ (Primary Contact)

Property ID:

1744379024

Page 1

Location Map:

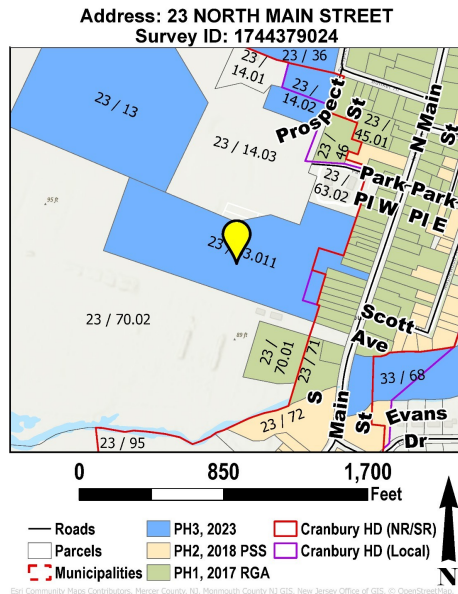

Site Map:

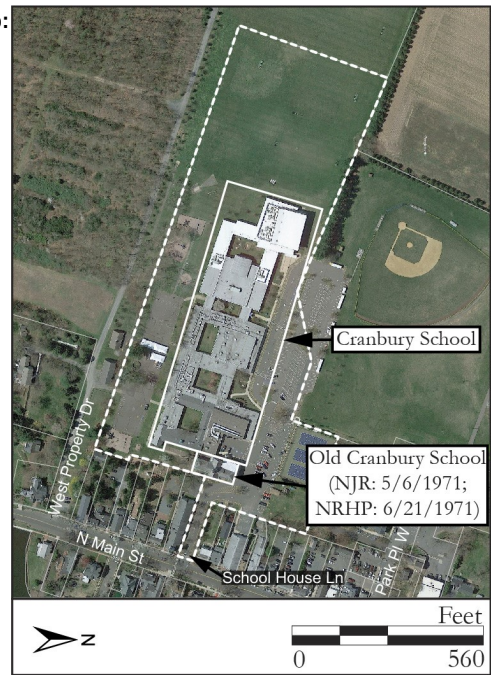

BIBLIOGRAPHY:

Author:	Title:	Year:	HPO Accession #:	(if applicable)
Richard Grubb & Associates, Inc.	Cranbury Township Historic Sites Survey Phase I, Cranbury Township, Middlesex County, New Jersey. Prepared for the Township of Cranbury Historic Preservation Commission. On file, New Jersey Historic Preservation Office, Trenton, New Jersey.	2017		

Additional Information:

Richard Grubb & Associates, Inc. recommended Old Cranbury School at 23 North Main Street as a contributing resource to the Cranbury Historic District in 2017. However, because the subject property is individually listed in the NRHP, Richard Grubb & Associates, Inc. recommends Old Cranbury School at 23 North Main Street as a key-contributing resource to the Cranbury Historic District. The school is an excellent, well-preserved example of its type, and retains sufficient integrity of materials, design, workmanship, setting, location, feeling, and association to convey the significance of the historic district.

More Research Needed? ☐ (checked=Yes)

INTENSIVE-LEVEL USE ONLY:

Attachments Included:

0 Building	0 Bridge
0 Structure	0 Landscape
0 Object	0 Industry

Historic District ? ☒

District Name: Cranbury Historic District

Status: Key Contributing

Associated Archeological Site/Deposits? ☐

(known or potential sites. If Yes, please describe briefly)

Conversion Problem? ☐ **ConversionNote:** 1202_23_63.011

Date form completed: 6/21/2023

Survey Name: Cranbury Historic Sites Survey Phase III

Surveyor: Kristen Herrick

Organization: Richard Grubb & Associates, Inc.

☐ (Primary Contact)

Property ID:

1744379024

Page 2

ELIGIBILITY WORKSHEET - Properties

Property ID **1744379024**

History:

No changes from the 2017 survey.

Statement of Significance:

No changes from the 2017 survey.

Eligibility for New Jersey and National Registers: ☒ Yes ☐ No

National Register Criteria: ☒ A ☐ B ☒ C ☐ D

Level of Significance: ☒ Local ☐ State ☐ National

Justification of Eligibility/Ineligibility:

No changes from the 2017 survey.

Total Number of Attachments: 0

List of Element Names:

Narrative Boundary Description:

The recommended boundary consists of the entirety of Block 62, Lot 63.011.

Date Form Completed: 8/14/2023

Survey Name: Cranbury Historic Sites Survey Phase III

Surveyor: Kristen Herrick

Organization: Richard Grubb & Associates, Inc.

☐ (Primary Contact)

Property ID:

1744379024

Page 3

PROPERTY REPORT: PHOTO CONTINUATION SHEET

Property ID: 1744379024

Property Name: Old Cranbury School

Address: 23 N Main ST



Photo 2



Photo 3

Property Name: Old Cranbury School

Address: 23 N Main ST



Photo 4



Photo 5

Property Name: Old Cranbury School

Address: 23 N Main ST



Photo 6



Photo 7

PROPERTY REPORT

Property ID: 1155271112

Property Name: Old Cranbury School

Ownership: Private

Address: 23 N Main ST

Apartment #:

ZIP: 08512

PROPERTY LOCATION(S):

County:	Municipality:	Local Place Name:	USGS Quad:	Block:	Lot:
MIDDLESEX	Cranbury township	Cranbury	Hightstown	23	63.011

Property Photo:



Old HSI Number:

NRIS Number:

HABS/HAER Number:

Description:

Old Cranbury School at 23 North Main Street is a two-story, nine-bay, three-pile brick school building constructed in 1896. The main block of the building has multiple rear additions where the public library and the current school administration and classrooms are located. It is the largest building in the Cranbury Historic District. Only the main block of the building is described here; it currently serves as offices for Cranbury Township.

The main block is comprised of the core, which has the shape of a Greek cross, plus two-story wings that were added in the early twentieth century. The cross-gabled roof is clad with asphalt shingles and features a course of decorative brackets attached onto a frieze and returns on the front gable. The centered cupola features a metal weathervane over a bell-shaped roof, paired ogee brackets, and a large clock over multi-light windows. The walls are brick, with brick belt courses running horizontally between the basement and first floor and the first and second floors. Decorative elements of the brick walls include a sealed ocular window on the attic level, sporadic use of glazed headers, and rowlock arches over the windows. The projecting center bay features three replacement windows with segmental arched heads below rowlock jackarches on the second floor. A portico attached onto the projecting bay consists of a second floor balcony with turned balusters and an entablature supported by Doric columns that announce the entrance. Paired doors with plate glass windows provide access to the interior; they open below a semi-circular transom with spiderweb tracery and a keystone. Replacement four-over-four windows below rowlock arches flank the entrance and are aligned over arched headed basement windows.

Survey Name: Cranbury CLG Survey 2017

Surveyor: Kristen Herrick

Organization: RGA, Inc.

☒ (Primary Contact)

Property ID:

1155271112

Page 1

The wings flanking the projecting center bay are nearly identical in appearance. Each has a gabled roof with a molded cornice supported by decorative brackets with a wood frieze, brick walls, and large tripartite multi-light windows on the first and second floors. On both wings, the bay abutting the projecting center bay contains a round second floor window over a replacement window with a segmental arched head on the first floor (originally doors).

The north end of the schoolhouse has been modified. At the top of the wall surface is the molded cornice. The eastern half of the cornice includes shaped brackets that are paired and attached onto a wood frieze; the west half of the cornice does not have the brackets or frieze. The brick wall surface includes the horizontal bands identifying the floor levels. Arched headed windows on the two upper floors have been bricked in, leaving limestone sills in place. The basement level features six arched headed four-light basement windows (possibly original to the section).

The south end of the schoolhouse has fewer modifications than the north end. At the top of the wall surface, the molded cornice extends along the entire elevation and features shaped brackets with a wood frieze. The brick walls include the horizontal bands announcing the floor levels. Fenestration on the end wall is strictly symmetrical, with four bays of windows on the first floor, second floor, and basement. Windows on the upper floors are replacement, arched headed four-over-four units. The basement level features arched headed two-over-two windows that also appear to be replacement units.

On the rear of the schoolhouse are multiple additions that range in date from circa 1950 to circa 2006. Character-defining elements of the building include a bracketed cornice, brick corbelling, a central projecting bay, and a central cupola.

History: The 1916 Sanborn Atlas shows the eastern portion of the building only, but at that time the wing off the north end had not been constructed. The 1933 Sanborn Atlas shows the main block of the schoolhouse as it currently appears. Historic aerials document the ongoing additions onto the building, beginning in the 1950s and continuing into the early twenty-first century.

Setting:

Old Cranbury School is sited on an irregularly-shaped parcel (Block 23, Lot 63.011) located on the east side of North Main Street in Cranbury Township, Middlesex County, New Jersey. The building is oriented with its primary elevation facing east. The property is accessed via School House Lane, which runs approximately 230 feet west from North Main Street to an expansive paved parking lot. Old Cranbury School is located in a mixed residential and commercial neighborhood surrounded by properties dating from the mid-nineteenth to the early twentieth century.

**Registration
and Status**

National Historic Landmark?: ☐

National Register: 9/18/1980

SHPO Opinion:

Dates:

New Jersey Register: 8/9/1979

Local Designation: 9/26/1988

Determination of Eligibility: 3/25/1977

Other Designation:

Certification of Eligibility:

Other Designation Date:

☐ **Eligibility Worksheet included in present survey?**

☐ **Is this Property an identifiable farm or former farm?**

Survey Name: Cranbury CLG Survey 2017

Surveyor: Kristen Herrick

Organization: RGA, Inc.

☒ (Primary Contact)

Property ID:

1155271112

Page 2

Location Map:

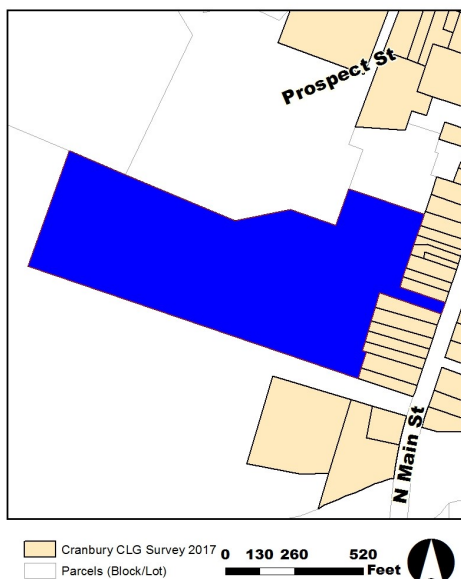

Site Map:

BIBLIOGRAPHY:

Author:	Title:	Year:	HPO Accession #:	(if applicable)
Walsh, Ruth	National Register of Historic Places Nomination for the Cranbury Historic District, Cranbury Township, Middlesex County, New Jersey	1979		

Additional Information:

Old Cranbury School was listed in the National Register of Historic Places (NRHP) on June 21, 1971. RGA recommends Old Cranbury School as a contributing resource due to its date of construction and design.

More Research Needed? ☐ (checked=Yes)

INTENSIVE-LEVEL USE ONLY:

Attachments Included: 0 Building 0 Bridge
0 Structure 0 Landscape
0 Object 0 Industry

Historic District ? ☒

District Name: Cranbury Historic District

Status: Contributing

Associated Archeological Site/Deposits? ☐

(known or potential sites. If Yes, please describe briefly)

Conversion Problem? ☐ ConversionNote: 89

Date form completed: 6/29/2017

Survey Name: Cranbury CLG Survey 2017

Surveyor: Kristen Herrick

Organization: RGA, Inc.

☒ (Primary Contact)

Property ID:

1155271112

Page 3