

PROPERTY REPORT

Property ID: **-647593056**

Property Name: 25 North Main Street

Ownership: Private

Address: 25 N Main ST

Apartment #:

ZIP: 08512

PROPERTY LOCATION(S):

County:	Municipality:	Local Place Name:	USGS Quad:	Block:	Lot:
MIDDLESEX	Cranbury township	Cranbury	Hightstown	23	63.03

Property Photo:



Old HSI Number:

NRIS Number:

HABS/HAER Number:

Description:

25 North Main Street is a two-story, three-bay, one-pile Greek Revival style residence constructed circa 1860. The main block faces east onto Main Street and has a full-width two-story rear addition.

The main block has a side-gabled roof is sheathed with asphalt shingles. The molded cornice doubles as an interior gutter system and is supported by thick molded brackets. An interior brick chimney pierces the ridge near the south end wall. The exterior of the dwelling is clad in aluminum siding. Fenestration is mostly symmetrical. Windows are one-over-one, double-hung, wood sash (replacement) with molded lintels and louvered shutters. A key feature of the main elevation is a two-story octagonal bay aligned with the south end wall. The bay features a flat roof with a molded cornice that is incorporated into the main cornice of the house (complete with the heavy brackets). The walls of the bay are clad with aluminum, with a slight second floor flare over the first floor (heavy brackets are located below this flare). Windows on the bay are all replacement one-over-one units with undersized louvered shutters, with a window on each panel and each floor. North of the bay, the wall has two second bays. The second floor has single window units, but the first floor has a paired window north of the entrance, a six-panel wood door, flanked by fluted columns and topped by a broken pediment with an urn between and dentil trim. In front of the door is a four-step brick porch with a concrete landing. The house has a stone foundation.

The south end wall faces onto School House Lane. At the top of the wall surface, the molded cornice is visible with its returns and

Survey Name: Cranbury CLG Survey 2017

Surveyor: Kristen Herrick

Organization: RGA, Inc.

☒ (Primary Contact)

Property ID:

-647593056

Page 1

brackets. The brick chimney is visible above the peak of the gable. The southern wall surface is clad with aluminum siding. The end wall has a single rank of windows, located near the southeast corner where the two main floors have a single one-over-one double hung sash (replacement) window flanked by louvered shutters. The north end of the house stands very near the neighboring house and is not easily visible from the public right-of-way.

The rear addition is a two-story section with a shed roof. The roof is clad with asphalt shingles and has simple overhanging eaves. The frame walls are clad with aluminum siding. Fenestration is asymmetrically spaced over the walls. Windows are six-over-six units with louvered shutters (late twentieth century units). The addition has a formal entrance on the south elevation, where a six-paneled door opens between fluted Doric pilasters supporting a broken pediment with dentil details and an urn. A brick stoop in front of the door includes brick steps down to the sidewalk along School House Lane.

Character-defining elements of the dwelling include the bracketed cornice, two-story projecting bay, and molded door surround featuring fluted pilasters and a broken pediment.

History: The 1916 Sanborn Atlas shows the house with its current appearance (front bay and rear addition included). In the rear of the lot was a chicken house. The 1933 Sanborn Atlas shows a few changes to the property since 1916. A one-story addition had been constructed onto the rear of the rear addition, and the chicken house had been demolished. The house appears on historic aerial maps beginning with 1940, but the small one-story rear addition shown on the 1933 Sanborn Atlas does not appear on the aerials.

Setting:

25 North Main Street is sited on a rectangular parcel (Block 23, Lot 63.03) located on the west side of North Main Street in Cranbury Township, Middlesex County, New Jersey. The parcel is bounded to the south by School House Lane and to the east by North Main Street. The dwelling is oriented with its primary elevation facing southeast and is set back approximately 10 feet from North Main Street. A concrete sidewalk, which runs along North Main Street, spans the east side of the parcel. A wood fence encloses the yard, planted in grass, to the rear (west) of the dwelling. Shrubs within brick planters abut the front (southeast) elevation. The parcel is lined with trees. 25 North Main Street is located in a mixed residential and commercial neighborhood surrounded by properties dating from the mid-nineteenth to the early twentieth century.

**Registration
and Status
Dates:**

National Historic Landmark?: ☐

National Register: 9/18/1980

New Jersey Register: 8/9/1979

Determination of Eligibility: 3/25/1977

Certification of Eligibility:

SHPO Opinion:

Local Designation: 9/26/1988

Other Designation:

Other Designation Date:

☐ **Eligibility Worksheet included in present survey?**

☐ **Is this Property an identifiable farm or former farm?**

Survey Name: Cranbury CLG Survey 2017

Surveyor: Kristen Herrick

Organization: RGA, Inc.

☒ (Primary Contact)

Property ID:

-647593056

Page 2

Location Map:

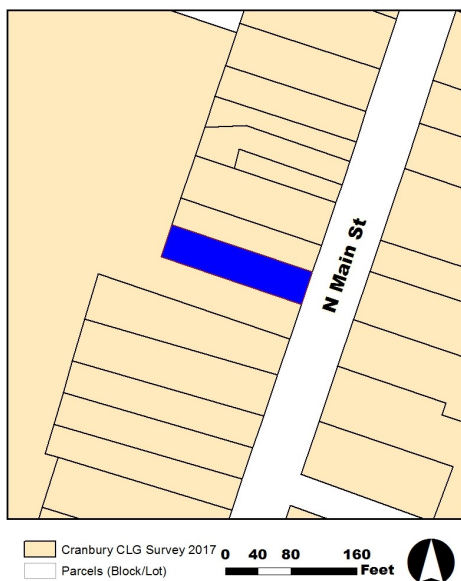

Site Map:

BIBLIOGRAPHY:

Author:	Title:	Year:	HPO Accession #:	(if applicable)
Walsh, Ruth	National Register of Historic Places Nomination for the Cranbury Historic District, Cranbury Township, Middlesex County, New Jersey	1979		
Heritage Studies	Preserving Historic Cranbury Village	1989		

Additional Information:

The 1989 Heritage Studies survey identified 25 North Main Street as a contributing resource to the Cranbury Historic District. RGA concurs with the previous evaluation and recommends 25 North Main Street as a contributing resource due to its date of construction.

More Research Needed? ☐ (checked=Yes)

INTENSIVE-LEVEL USE ONLY:

Attachments Included:

<input type="checkbox"/> Building	<input type="checkbox"/> Bridge
<input type="checkbox"/> Structure	<input type="checkbox"/> Landscape
<input type="checkbox"/> Object	<input type="checkbox"/> Industry

Historic District ? ☐

District Name: Cranbury Historic District

Status: Contributing

Associated Archeological Site/Deposits? ☐

(known or potential sites. If Yes, please describe briefly)

Conversion Problem? ☐ **ConversionNote:** 97

Date form completed: 6/26/2017

Survey Name: Cranbury CLG Survey 2017

Surveyor: Kristen Herrick

Organization: RGA, Inc.

☒ (Primary Contact)

Property ID:

-647593056

Page 3