

## PROPERTY REPORT

Property ID: **-1758331974**

**Property Name:** Samuel Disbrow, Jr. House  
**Address:** 13 N Main ST

**Ownership:** Private  
**Apartment #:** **ZIP:** 08512

### PROPERTY LOCATION(S):

County:	Municipality:	Local Place Name:	USGS Quad:	Block:	Lot:
MIDDLESEX	Cranbury township	Cranbury	Hightstown	23	67

### Property Photo:



**Old HSI Number:**

**NRIS Number:**

**HABS/HAER Number:**

### Description:

The Samuel Disbrow, Jr. House at 13 North Main Street is a two-story tall, three-bay wide, six-bay deep, frame commercial building constructed in 1810 with Greek Revival details. The building consists of a rectangular, front-gabled main block and a two-story, two-bay wide rear addition (constructed before 1916). The roof is sheathed with asphalt shingles and features a molded wood cornice with a return cornice at the front gable end. The exterior of the building is clad in wood clapboard siding on all elevations. On the front elevation, a wood ocular window (dating to the 1850s) sits in the gable end. Three six-over-six, double-hung, wood-sash windows (likely original) are located on the second floor, spaced evenly across the façade. The first floor has two large picture windows (replacement) on either side of the entrance, a single door with four inset lights above two rectangular panels. A pediment-front entry porch with unfluted Doric columns shelters the entrance. Access is gained via a brick stoop. The north elevation features a wood frieze beneath the slightly overhanging eaves. Windows on the north elevation of the main block and rear addition are six-over-six, double-hung wood-sash (likely original) with molded wood lintels. A wood frieze runs beneath the overhanging eaves on the south elevation. Windows on the south elevation of the main block and rear addition are six-over-six, double-hung, wood-sash windows with molded wood lintels. Two secondary entrances, single doors with four inset lights above two rectangular panels, are located in the east-center bay on the main block and in the west bay on the rear addition. The rear elevation is not visible from the public right-of-way. The foundation is not visible beneath the wood clapboard siding. Character-defining elements of the building include the wood ocular window in the front gable end, the molded wood return cornice, and wood-sash windows.

**Survey Name:** Cranbury CLG Survey 2017

**Surveyor:** Kristen Herrick

**Organization:** RGA, Inc.

☒ (Primary Contact)

**Property ID:**

**-1758331974**

Page 1

History: The subject building was constructed by Samuel Disbrow, Jr., circa 1810. It first appears cartographically on the 1861 Walling map of Cranbury Township, labelled as a harness shop. On the 1872 Beers atlas, the subject building is owned by "S.B. Sutton," referring to Stafford B. Sutton, who purchased the property in 1869 (Cranbury Historical and Preservation Society n.d.) The 1876 Everts and Stewart map shows no changes in ownership. From 1892 to 1979, the Samuel Disbrow, Jr. House hosted the offices, typesetting, and pressrooms of the Cranbury Press, the town's weekly newspaper (Chambers 2012:77-78). The Samuel Disbrow, Jr. House also served as the first location of the Cranbury Free Public Library, established in 1906 (Cranbury Tercentennial Committee 1997:55). The 1916 Sanborn map of Cranbury Township shows the subject building's two-story rear addition, a full-length front porch, and a one-story rear addition used for coal storage. The east half of the subject building functioned as a private residence while the west half served as a printing room for the Cranbury Press. The 1933 Sanborn map indicates no changes to the subject building. According to historic aerial photographs, the one-story rear addition was removed circa 1950. The full-length front porch was removed circa 1970.

#### Setting:

The Samuel Disbrow, Jr. House at 13 North Main Street is sited on a rectangular parcel (Block 23, Lot 67) located on the west side of North Main Street in Cranbury Township, Middlesex County, New Jersey. The building is oriented with its primary elevation facing east and is set back approximately 10 feet from North Main Street. The portion of the sidewalk that spans the east side of the parcel is paved with bricks. A paved driveway leads west from North Main Street, past the building's south elevation, to a gravel parking lot. The property is lightly wooded. The Samuel Disbrow, Jr. House at 13 North Main Street is located in a mixed residential and commercial neighborhood surrounded by properties dating from the mid-nineteenth to the early twentieth century.

#### Registration and Status Dates:

National Historic Landmark?: ☐

National Register: 9/18/1980

New Jersey Register: 8/9/1979

Determination of Eligibility: 3/25/1977

Certification of Eligibility:

SHPO Opinion:

Local Designation: 9/26/1988

Other Designation:

Other Designation Date:

☐ Eligibility Worksheet included in present survey?

☐ Is this Property an identifiable farm or former farm?

#### Location Map:

#### Site Map:

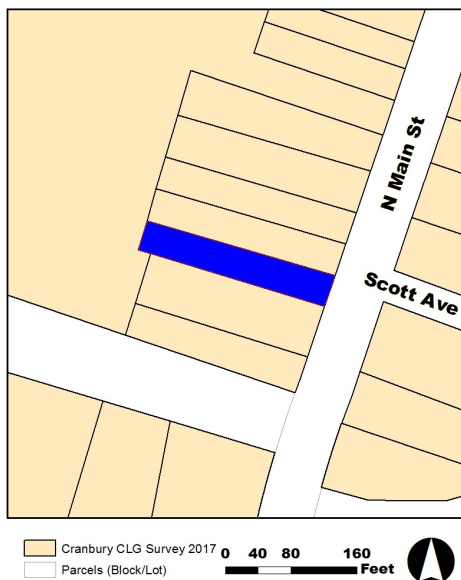

#### BIBLIOGRAPHY:

Author:	Title:	Year:	HPO Accession #:	(if applicable)
Walsh, Ruth	National Register of Historic Places Nomination for the Cranbury Historic District, Cranbury Township, Middlesex County, New Jersey	1979		

Survey Name: Cranbury CLG Survey 2017

Surveyor: Kristen Herrick

Organization: RGA, Inc.

☒ (Primary Contact)

Property ID:

-1758331974

Page 2

Heritage Studies	Preserving Historic Cranbury Village	1989
Cranbury Tercentennial Committee	Cranbury: 1697-1997	1997
Chambers, John Whiteclay II	Cranbury: A New Jersey Town from the Colonial Era to the Present	2012

**Additional Information:**

The 1989 Heritage Studies survey identified the Samuel Disbrow, Jr. House at 13 North Main Street as a contributing resource to the Cranbury Historic District. RGA concurs with the previous evaluation and recommends the Samuel Disbrow, Jr. House at 13 North Main Street as a contributing resource due to its date of construction, design, and use of materials compatible with the district.

**More Research Needed?** ☐ (checked=Yes)

---

**INTENSIVE-LEVEL USE ONLY:**

**Attachments Included:**

0 Building	0 Bridge
0 Structure	0 Landscape
0 Object	0 Industry

**Historic District ?** ☒

**District Name:** Cranbury Historic District

**Status:** Contributing

**Associated Archeological Site/Deposits?** ☐

(known or potential sites. If Yes, please describe briefly)

---

Conversion Problem? ☐ ConversionNote: 103

*Date form completed:* 6/26/2017

---

**Survey Name:** Cranbury CLG Survey 2017

**Surveyor:** Kristen Herrick

**Organization:** RGA, Inc.

☒ (Primary Contact)

**Property ID:**

**-1758331974**

Page 3