

## PROPERTY REPORT

Property ID: 1690302342

**Property Name:** North Main Street Agricultural Field

**Ownership:** Private

**Address:** N Main ST

**Apartment #:**

**ZIP:** 08512

**PROPERTY LOCATION(S):**

County:	Municipality:	Local Place Name:	USGS Quad:	Block:	Lot:
MIDDLESEX	Cranbury township	Cranbury	Hightstown	25	19.01

**Property Photo:**



**Old HSI Number:**

**NRIS Number:**

**HABS/HAER Number:**

**Description:**

Block 25, Lot 19.01 is a 62.38-acre parcel with frontage on the west side of North Main Street. The site consists of an open agricultural field.

Character-defining elements of the site include its pastoral setting, absence of buildings or structures, and scenic vistas of farmland as viewed from North Main Street.

History: Block 25, Lot 19.01 was historically part of a large landholding purchased by Ezekiel Barclay in 1924 (Middlesex County Clerk's Office [MCCO] 1924 Deed Book 771:49). Aerial photographs throughout the twentieth century and into the twenty-first century show that the subject parcel was actively farmed and remained undeveloped (Nationwide Environmental Title Research 1931, 1957, 1979, 1987, 2002). In 2004, the subject parcel was preserved by the New Jersey State Agriculture Development Committee, which acquired the development rights and placed restrictions on the site (MCCO 2004 Deed Book 5392:83). The subject parcel is presently known as the "Barclay North" farm (Township Committee of the Township of Cranbury 2004).

**Setting:**

Block 25, Lot 19.01 is a roughly rectangular-shaped parcel located on the northwest side of North Main Street in Cranbury Township, Middlesex County, New Jersey. The subject parcel is adjoined to the west by open farmland, and to the north by a dense thicket of mature hardwood trees. The subject parcel is located in a residential neighborhood surrounded by properties dating from the mid-nineteenth to the late twentieth centuries.

**Registration**

**National Historic Landmark?:** ☐

**Status**

**National Register:** 9/18/1980

**SHPO Opinion:**

**Dates:**

**New Jersey Register:** 8/9/1979

**Local Designation:** 9/26/1988

**Determination of Eligibility:** 3/25/1977

**Other Designation:**

**Certification of Eligibility:**

**Other Designation Date:**

☐ **Eligibility Worksheet included in present survey?**

☐ **Is this Property an identifiable farm or former farm?**

**Survey Name:** Cranbury Historic Sites Survey Phase III

**Property ID:**

Page 1

**Surveyor:** Kristen Herrick

☒ (Primary Contact)

1690302342

**Organization:** Richard Grubb & Associates, Inc.

Location Map:

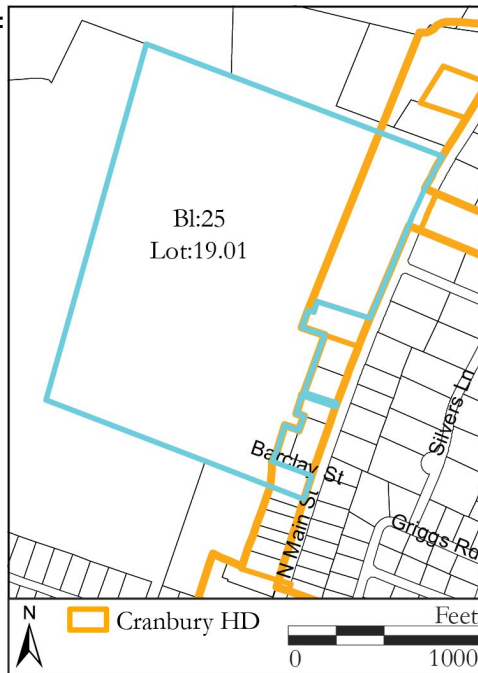

Site Map:

**BIBLIOGRAPHY:**

Author:	Title:	Year:	HPO Accession #:	(if applicable)
Township Committee of the Township of Cranbury	Township Committee Meeting minutes, June 28, 2004. Electronic document, <a href="https://www.cranburytownship.org/sites/g/files/vyhlf4296/f/minutes/tc_minutes062804.pdf">https://www.cranburytownship.org/sites/g/files/vyhlf4296/f/minutes/tc_minutes062804.pdf</a> , accessed June 2023.	2004		
Middlesex County Clerk's Office (MCCO)	On file, Middlesex County Clerk's Office, New Brunswick, New Jersey.			
Nationwide Environmental Title Research (NETR)	Historic Aerial Photograph. Electronic document, <a href="http://www.historicaerials.com">www.historicaerials.com</a> , accessed June 2023.	1931		
Nationwide Environmental Title Research (NETR)	Historic Aerial Photograph. Electronic document, <a href="http://www.historicaerials.com">www.historicaerials.com</a> , accessed June 2023.	1957		
Nationwide Environmental Title Research (NETR)	Historic Aerial Photograph. Electronic document, <a href="http://www.historicaerials.com">www.historicaerials.com</a> , accessed June 2023.	1979		
Nationwide Environmental Title Research	Historic Aerial Photograph. Electronic document, <a href="http://www.historicaerials.com">www.historicaerials.com</a> , accessed June 2023.	1987		
Nationwide Environmental Title Research	Historic Aerial Photograph. Electronic document, <a href="http://www.historicaerials.com">www.historicaerials.com</a> , accessed June 2023.	2002		

**Additional Information:**

Richard Grubb & Associates, Inc. recommends Block 25, Lot 19.01 as a contributing resource to the Cranbury Historic District. The site retains sufficient integrity of location, setting, feeling, and association to convey the significance of the historic district.

More Research Needed? ☐ (checked=Yes)

**INTENSIVE-LEVEL USE ONLY:**

Attachments Included: 0 Building 0 Bridge  
0 Structure 0 Landscape  
0 Object 0 Industry

Historic District ? ☒

District Name: Cranbury Historic District

Status: Contributing

Survey Name: Cranbury Historic Sites Survey Phase III

Surveyor: Kristen Herrick

Organization: Richard Grubb & Associates, Inc.

☒ (Primary Contact)

Property ID:

1690302342

Page 2

**Associated Archeological Site/Deposits?** ☐  
(known or potential sites. If Yes, please describe briefly)

---

Conversion Problem? ☐ ConversionNote: Null

Date form completed: 7/25/2023

---

**Survey Name:** Cranbury Historic Sites Survey Phase III

**Surveyor:** Kristen Herrick

**Organization:** Richard Grubb & Associates, Inc.

☒ (Primary Contact)

**Property ID:**

**1690302342**

Page 3