

PROPERTY REPORT

Property ID: -1719866505

Property Name: 115 North Main Street
Address: 115 N Main ST

Ownership: Private
Apartment #:
ZIP: 08512

PROPERTY LOCATION(S):

County:	Municipality:	Local Place Name:	USGS Quad:	Block:	Lot:
MIDDLESEX	Cranbury township	Cranbury	Hightstown	25	27

Property Photo:



Old HSI Number:

NRIS Number:

HABS/HAER Number:

Description:

115 North Main Street is a two-and-one-half-story-tall, four-bay-wide, two-bay-deep, frame dwelling built circa 1910 and expanded circa 1965. The original block of the dwelling consists of the southwest two bays, with the northeastern two bays representing the circa-1965 addition. The dwelling is capped by an asphalt-shingle, hipped roof. An interior brick chimney rises from the southwest roof slope and an exterior brick chimney is centered on the northeast elevation. A gabled dormer is located above the southwesternmost bay of the primary (southeast) elevation and features a three-light wood window in a wood surround (likely original). The exterior of the dwelling is clad in vinyl siding. Windows throughout are one-over-one, vinyl-sash replacement units, set within wood surrounds, some of which have molded wood lintels (likely original). The primary elevation has asymmetrical fenestration with inoperable, vinyl louvered shutters flanking the windows. In the southwesternmost bay, there is a semi-hexagonal projecting bay with a hipped roof. The central, primary entrance contains a wood paneled door with a metal storm door, set into a wood surround with fluted pilasters and a broken pediment. The entrance is accessed by a brick stoop with stone coping and wood railings. The southwest elevation has symmetrical fenestration with two windows on the first and second floors. The northeast elevation contains a secondary entrance with a metal storm door and is devoid of other openings. The first floor of the northeast elevation is sheltered by a gabled porch supported by vinyl Doric columns. The rear (northwest) elevation is not visible from the public right-of-way. The original block of the dwelling stands on a rusticated cast-stone foundation, while the circa-1965 addition stands on a concrete foundation.

A circa-1995 vinyl shed stands approximately 100 feet northwest of the dwelling.

History: 115 North Main Street is an example of an early twentieth-century, vernacular dwelling in Cranbury. The main block of the subject dwelling stylistically dates to circa 1910 and appears to have been originally constructed in a foursquare plan. The subject dwelling, along with the neighboring dwelling at 113 North Main Street, was built on a roughly one-acre parcel of land purchased by Elizabeth Dye in 1909 (Middlesex County Clerk's Office [MCCO] Deed Book 443:203). In 1917, Elizabeth's son, David Dye, purchased the roughly one-acre parcel that included the subject dwelling and the dwelling at 113 North Main Street from his mother's estate (MCCO 1917 Deed Book 605:279). It is unclear whether Elizabeth or David Dye ever lived in the subject dwelling, and it is possible that the subject dwelling was rented by tenants during the period between about 1910 and 1920. In 1921, Minnie Peterson purchased the one-acre parcel that included the subject dwelling and the dwelling at 113 North Main Street from David Dye and his wife, Nellie (MCCO 1921 Deed Book 712:9). The 1930 federal census lists Minnie Peterson and her husband, Jeremiah, a house painter, as residents of North Main Street in Cranbury;

Survey Name: Cranbury Historic Sites Survey Phase III

Surveyor: Matthew Goldberg

Organization: Richard Grubb & Associates, Inc.

☒ (Primary Contact)

Property ID:

-1719866505

Page 1

however, it is unclear whether they were residing in the subject dwelling or in the dwelling at 113 North Main Street (United States Bureau of the Census 1930). In 1946, the Petersons subdivided the one-acre parcel and sold the subject dwelling to Charles and Evelyn Livingston (MCCO 1946 Deed Book 1297:394). Around 1965, the subject dwelling was expanded to the northeast, roughly doubling its size, and a side-gabled porch was added to the northeast elevation (Nationwide Environmental Title [NETR] 1963, 1969). Around 1995, a vinyl shed was built northwest of the dwelling (NETR 1987, 1995, 2002). Sometime during the late twentieth or early twenty-first centuries, the current vinyl siding and vinyl-sash windows were installed.

Setting:

115 North Main Street is sited on a rectangular parcel (Block 25, Lot 27) located on the northwest side of North Main Street in Cranbury Township, Middlesex County, New Jersey. The dwelling is oriented with its primary elevation facing southeast and is set back approximately 30 feet from the road. An asphalt-paved driveway extends along the southwest border of the property. A concrete path extends from the roadway to the primary entrance. A brick path leads from the driveway to the primary entrance. Mature trees and shrubs are planted within close proximity to the dwelling. The subject property is located in a residential neighborhood surrounded by properties dating from the mid-nineteenth to the late twentieth centuries.

**Registration
and Status
Dates:**

National Historic Landmark?: ☐

National Register: 9/18/1980

New Jersey Register: 8/9/1979

Determination of Eligibility: 3/25/1977

Certification of Eligibility:

SHPO Opinion:

Local Designation: 9/26/1988

Other Designation:

Other Designation Date:

☐ **Eligibility Worksheet included in present survey?** ☐ **Is this Property an identifiable farm or former farm?**

Location Map:

Site Map:

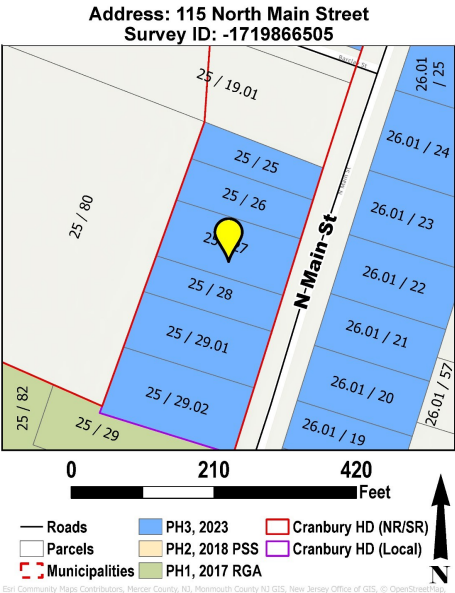

BIBLIOGRAPHY:

Author:	Title:	Year:	HPO Accession #: (if applicable)
Heritage Studies	Preserving Historic Cranbury Village. Prepared for the Cranbury Township Historic Preservation Advisory Committee.	1989	
Middlesex County Clerk's Office	On file, Middlesex County Clerk's Office, New Brunswick, New Jersey.		
Nationwide Environmental Title Research (NETR)	Historic Aerial Photograph. Electronic Document, http://www.historicaerials.com , accessed May 2023.	1963	
Nationwide Environmental Title Research (NETR)	Historic Aerial Photograph. Electronic Document, http://www.historicaerials.com , accessed May 2023.	1969	
Nationwide Environmental Title Research (NETR)	Historic Aerial Photograph. Electronic Document, http://www.historicaerials.com , accessed May 2023.	1987	
Nationwide Environmental Title Research (NETR)	Historic Aerial Photograph. Electronic Document, http://www.historicaerials.com , accessed May 2023.	1995	

Survey Name: Cranbury Historic Sites Survey Phase III

Surveyor: Matthew Goldberg

Organization: Richard Grubb & Associates, Inc.

☒ (Primary Contact)

Property ID:

-1719866505

Page 2

Nationwide Environmental Title Research (NETR)	Historic Aerial Photograph. Electronic Document, http://www.historicaerials.com , accessed May 2023.	2002
New Jersey Department of Environmental Protection	NJ-GeoWeb. Electronic Document, https://www.nj.gov/dep/gis/geoweb splash.htm , accessed May 2023.	1930
Walsh, Ruth	National Register of Historic Places Nomination Form for the Cranbury Historic District, Township of Cranbury, Middlesex County, New Jersey. On file, New Jersey Historic Preservation Office, Trenton, New Jersey.	1980
United States Bureau of the Census	Population Schedule, Township of Cranbury, Middlesex County, New Jersey.	1930

Additional Information:

The dwelling at 115 North Main Street was identified in the 1980 Cranbury Historic District National Register of Historic Places nomination and evaluated as a contributing resource in the 1989 Heritage Studies inventory of the district (Walsh 1980; Heritage Studies 1989). Richard Grubb & Associates, Inc. recommends 115 North Main Street as a non-contributing resource to the Cranbury Historic District due to its low integrity of materials, design, and workmanship. The circa-1965 expansion of the subject dwelling distorts the original massing of the building.

More Research Needed? ☐ (checked=Yes)

INTENSIVE-LEVEL USE ONLY:

Attachments Included:

<input type="checkbox"/> Building	<input type="checkbox"/> Bridge
<input type="checkbox"/> Structure	<input type="checkbox"/> Landscape
<input type="checkbox"/> Object	<input type="checkbox"/> Industry

Historic District ? ☒

District Name: Cranbury Historic District

Status: Non Contributing

Associated Archeological Site/Deposits? ☐

(known or potential sites. If Yes, please describe briefly)

Conversion Problem? ☐ ConversionNote: 1202_25_27

Date form completed: 6/21/2023

Survey Name: Cranbury Historic Sites Survey Phase III

Surveyor: Matthew Goldberg

Organization: Richard Grubb & Associates, Inc.

☒ (Primary Contact)

Property ID:

-1719866505

Page 3

PROPERTY REPORT: PHOTO CONTINUATION SHEET

Property ID: -1719866505

Property Name: 115 North Main Street

Address: 115 N Main ST



Photo 2



Photo 3