

## PROPERTY REPORT

Property ID: 1778099796

**Property Name:** 110 North Main Street

**Ownership:** Private

**Address:** 110 N Main ST

**Apartment #:**

**ZIP:** 08512

### PROPERTY LOCATION(S):

County:	Municipality:	Local Place Name:	USGS Quad:	Block:	Lot:
MIDDLESEX	Cranbury township	Cranbury	Highstown	26.01	17.01

### Property Photo:



**Old HSI Number:**

**NRIS Number:**

**HABS/HAER Number:**

### Description:

110 North Main Street is a heavily altered Bungalow that faces west. The multiple additions and alterations have given the house a rambling appearance and have greatly undermined the building's historic appearance. It is comprised of a one-and-a-half story, three-bay core that has a two-story octagonal bay to the south, a large one-and-a-half story rear extension, and a one-and-a-half story wing extending to the north. The core was constructed circa 1915. The roof of the entire house is clad with asphalt shingles and features two interior brick chimneys. On the front of the core, a hipped-roof dormer has a paired six-over-six replacement window with vinyl sashes. The eaves are clad with vinyl siding. The exterior of the dwelling is clad in wood shingles. Fenestration consists of replacement vinyl-sash windows with multiple inset lights. The front porch extends along the entire front of the core; it has a hipped roof supported by five thin square columns (replacement). The entrance is a single French door with multiple inset lights within a molded wood surround. The south elevation of the core has the same cladding as the main elevation. A two-story octagonal bay also has asphalt shingles on the roof and wood shingled walls; the front panel of the bay features a paired (replacement) window on the second floor and a single-light window on the first floor; the side panels feature replacement six-over-six vinyl sash replacement windows. The rear extension is clad with stucco and features a one-story octagonal bay with multi-light windows. The wing off the north elevation of the core dominates its elevation. The wing has a hipped roof with an engaged exterior brick chimney on its north wall. Two through-the-cornice wall dormers protrude slightly from the wall surface and contain paired, multi-light windows. The north elevation of the wing has no wall openings. The wing has a concrete foundation. Character-defining elements of the building include hipped roof dormers and multiple projecting bays.

**Survey Name:** Cranbury CLG Survey 2017

**Surveyor:** Kristen Herrick

**Organization:** RGA, Inc.

**Property ID:**

Page 1

☒ (Primary Contact)

1778099796

History: The property is not shown on the 1916 Sanborn Atlas. The Sanborn Atlas of 1933 shows the house as a T-shaped frame building with a wider front porch and a small addition to the southwest. The detached garage is not shown on the Sanborn of 1933; it first clearly appears on historic aerials in 1979, but the aerials of 1963 and 1970 may show it. The historic aerials are difficult to interpret for this property in the mid-twentieth century. The addition on the rear of the house is first clearly depicted in historic aerial photography in 1979.

**Setting:**

110 North Main Street is sited on a rectangular parcel (Block 26.01, Lot 17.01) located east side of North Main Street in Cranbury Township, Middlesex County, New Jersey. The dwelling is oriented with its primary elevation facing northwest and is set back approximately 15 feet from North Main Street. A concrete sidewalk spans the west side of the parcel. A paved driveway leads east from North Main Street to the property's lightly wooded backyard. A one-story frame shed is located east of the dwelling. 110 North Main Street is located in a primarily residential neighborhood surrounded by residential properties dating from the mid-nineteenth to the early twentieth centuries.

**Registration  
and Status  
Dates:**

**National Historic Landmark?:** ☐

**National Register:** 9/18/1980

**New Jersey Register:** 8/9/1979

**Determination of Eligibility:** 3/25/1977

**Certification of Eligibility:**

**SHPO Opinion:**

**Local Designation:** 9/26/1988

**Other Designation:**

**Other Designation Date:**

☐ **Eligibility Worksheet included in present survey?**

☐ **Is this Property an identifiable farm or former farm?**

**Location Map:**

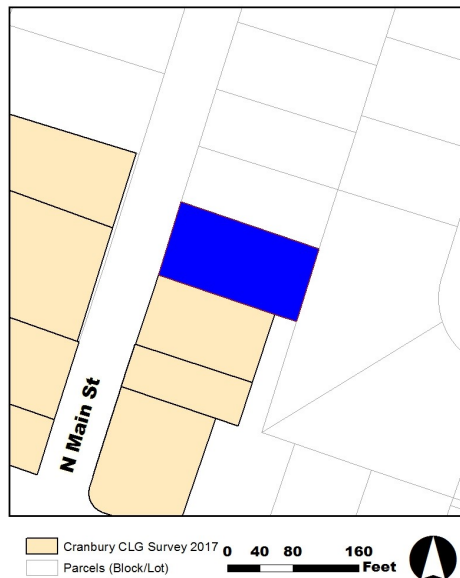

**Site Map:**

**BIBLIOGRAPHY:**

Author:	Title:	Year:	HPO Accession #:	(if applicable)
Walsh, Ruth	National Register of Historic Places Nomination for the Cranbury Historic District, Cranbury Township, Middlesex County, New Jersey	1979		
Heritage Studies	Preserving Historic Cranbury Village	1989		

**Additional Information:**

The 1989 Heritage Studies survey identified 110 North Main Street as a contributing resource to the Cranbury Historic District. However, the subject dwelling has since undergone extensive alterations. Therefore, RGA recommends 110 North Main Street as a non-contributing resource to the district.

**Survey Name:** Cranbury CLG Survey 2017

**Surveyor:** Kristen Herrick

**Organization:** RGA, Inc.

☒ (Primary Contact)

**Property ID:**

**1778099796**

Page 2

More Research Needed? ☐ (checked=Yes)

---

**INTENSIVE-LEVEL USE ONLY:**

**Attachments Included:**

<input type="checkbox"/> Building	<input type="checkbox"/> Bridge
<input type="checkbox"/> Structure	<input type="checkbox"/> Landscape
<input type="checkbox"/> Object	<input type="checkbox"/> Industry

**Historic District ?** ☒

**District Name:** Cranbury Historic District

**Status:** Non Contributing

**Associated Archeological Site/Deposits?** ☐

(known or potential sites. If Yes, please describe briefly)

---

Conversion Problem? ☐ ConversionNote: 93

*Date form completed:* 7/25/2017

---

**Survey Name:** Cranbury CLG Survey 2017

**Surveyor:** Kristen Herrick

**Organization:** RGA, Inc.

☒ (Primary Contact)

**Property ID:**

**1778099796**

Page 3