

PROPERTY REPORT

Property ID: -1448494467

Property Name: 112 North Main Street
Address: 112 N Main ST

Ownership: Private
Apartment #: **ZIP:** 08512

PROPERTY LOCATION(S):

County:	Municipality:	Local Place Name:	USGS Quad:	Block:	Lot:
MIDDLESEX	Cranbury township	Cranbury	Hightstown	26.01	18

Property Photo:



Old HSI Number:

NRIS Number:

HABS/HAER Number:

Description:

112 North Main Street is a one-and-one-half-story-tall, four-bay-wide, frame dwelling constructed circa 1950 in the Minimal Traditional style. The dwelling consists of a side-gabled main block with a one-story, side-gable southwest wing. The roof of the main block is interrupted by symmetrically placed, gable-roof dormers on the primary (northwest) slope (added circa 2004) and a full length, shed-roof dormer (added circa 2004) on the southeast slope. The roof, accented by overhanging eaves, is covered by asphalt shingles throughout. An off-center, exterior, concrete block chimney pierces the northeast gable end. The exterior of the dwelling is clad in wood clapboard siding. Windows are all single and paired, six-over-six or eight-over-eight, vinyl-sash replacement units. The primary elevation has asymmetrical fenestration with six-over-six, vinyl-sash windows in the two northernmost bays and a square bay window in the southernmost bay. Windows on this elevation are all set within wood surrounds (likely original). The central, primary entrance contains a paneled wood door (likely original) with a metal storm door, set within a wood surround with a slightly molded lintel (likely original). The entrance is sheltered by a front-gabled portico with wood Doric columns. Both the northeast and southwest elevations of the dwelling have asymmetrical fenestration. The southwest wing contains a six-over-six, vinyl-sash window on its northwest elevation and a paired vinyl-sash windows centered in its southwest elevation. The rear elevation is not visible from the public right-of-way. The dwelling stands on a concrete foundation.

A one-story-tall, two-bay-wide, concrete block garage, built circa 1950, stands approximately 13 feet southeast of the dwelling. It has an asphalt-shingle, front-gabled roof with wood clapboard siding in the gable end. The primary (northwest) elevation contains two wood panel roll-top doors (likely original). Both the southwest and northeast elevations have symmetrical fenestration with (likely original). The rear (southeast) elevation is not visible from the public right-of-way.

History: 112 North Main Street, constructed circa 1950, is an example of a mid-twentieth-century, Minimal Traditional-style dwelling in Cranbury. In 1947, the subject parcel was sold to William and Katherine Ziegler as an empty lot (Middlesex County Clerk's Office 1947 Deed Book 1384:203; Nationwide Environmental Title Research [NETR] 1947). William Ziegler worked as a dairy truck driver, and Katherine was an assistant cook at a school cafeteria. They lived at 112 North Main Street with their two sons (U.S. Census 1950). The subject dwelling and the extant detached garage are both visible on a 1953 aerial photograph in nearly their current forms (NETR 1953). Around 1970, a small, gable-roof dormer was added on the rear slope of the dwelling (NETR 1969, 1970). Between 2002 and 2006, two gable-roof dormers were built on the dwelling's primary slope, and the circa-1970 dormer on the rear slope was replaced with the extant

Survey Name: Cranbury Historic Sites Survey Phase III

Surveyor: Spencer Rubino

Organization: Richard Grubb & Associates, Inc.

☒ (Primary Contact)

Property ID:

-1448494467

Page 1

shed-roof dormer (NETR 2002, 2006). The extant vinyl-sash windows were likely installed sometime during the late twentieth or early twenty-first centuries. Sometime between 2019 and the present day, the extant vinyl siding was installed on the dwelling (Google 2019).

Setting:

112 North Main Street is sited on a roughly rectangular-shaped parcel (Block 26.01, Lot 18) located on the southeast side of North Main Street in Cranbury Township, Middlesex County, New Jersey. The dwelling is oriented with its primary elevation facing northwest and is set back approximately 35 feet from the road. An asphalt-paved driveway extends southeast from North Main Street and leads to the garage. Mature trees and shrubs are planted within close proximity to the dwelling. The subject dwelling is located in a residential neighborhood surrounded by properties generally dating from the mid-nineteenth to the late twentieth centuries.

**Registration
and Status
Dates:**

National Historic Landmark?: ☐

National Register: 9/18/1980

New Jersey Register: 8/9/1979

Determination of Eligibility: 3/25/1977

Certification of Eligibility:

SHPO Opinion:

Local Designation: 9/26/1988

Other Designation:

Other Designation Date:

☐ **Eligibility Worksheet included in present survey?**

☐ **Is this Property an identifiable farm or former farm?**

Location Map:

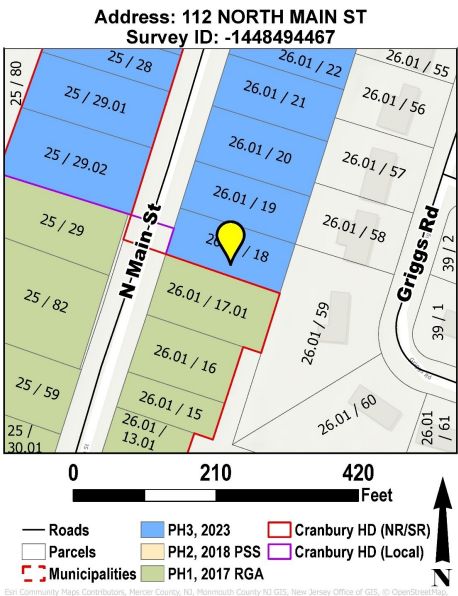

Site Map:

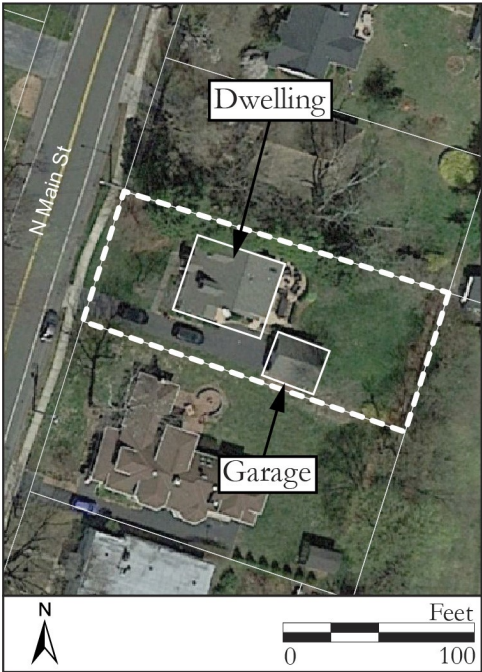

BIBLIOGRAPHY:

Author:	Title:	Year:	HPO Accession #: (if applicable)
Google	Google Street View. Electronic document, www.maps.google.com, accessed June 2023.	2019	
Heritage Studies	Preserving Historic Cranbury Village. Prepared for the Cranbury Township Historic Preservation Advisory Committee.	1989	
Middlesex County Clerk's Office	On file, Middlesex County Clerk's Office, New Brunswick, New Jersey.		
Nationwide Environmental Title Research (NETR)	Historic Aerial Photograph. Electronic document, https://www.historicaerials.com, accessed May 2023.	1947	
Nationwide Environmental Title Research (NETR)	Historic Aerial Photograph. Electronic document, https://www.historicaerials.com, accessed May 2023.	1953	
Nationwide Environmental Title Research (NETR)	Historic Aerial Photograph. Electronic document, https://www.historicaerials.com, accessed May 2023.	1969	
Nationwide Environmental Title Research (NETR)	Historic Aerial Photograph. Electronic document, https://www.historicaerials.com, accessed May 2023.	1970	
Nationwide Environmental Title Research (NETR)	Historic Aerial Photograph. Electronic document, https://www.historicaerials.com, accessed June 2023.	2002	

Survey Name: Cranbury Historic Sites Survey Phase III

Surveyor: Spencer Rubino

Organization: Richard Grubb & Associates, Inc.

☒ (Primary Contact)

Property ID:

-1448494467

Page 2

Research (NETR)

Nationwide Environmental Title Research (NETR)	Historic Aerial Photograph. Electronic document, https://www.historicaerials.com, accessed June 2023.	2006
United States Bureau of the Census	Population Schedule, Cranbury Township, Middlesex County, New Jersey.	1950
Walsh, Ruth	National Register of Historic Places Nomination Form for the Cranbury Historic District, Township of Cranbury, Middlesex County, New Jersey. On file, New Jersey Historic Preservation Office, Trenton, New Jersey.	1980

Additional Information:

Although the dwelling at 112 North Main Street was not identified in the 1980 Cranbury Historic District National Register of Historic Places nomination form, it was evaluated as a non-contributing (intrusion) resource in the 1989 Heritage Studies inventory of the district (Walsh 1980; Heritage Studies 1989). Richard Grubb & Associates, Inc. recommends 112 North Main Street as a non-contributing resource to the Cranbury Historic District due to its date of construction.

More Research Needed? ☐ (checked=Yes)

INTENSIVE-LEVEL USE ONLY:

Attachments Included:

0 Building	0 Bridge
0 Structure	0 Landscape
0 Object	0 Industry

Historic District ? ☒

District Name: Cranbury Historic District

Status: Non Contributing

Associated Archeological Site/Deposits? ☐

(known or potential sites. If Yes, please describe briefly)

Conversion Problem? ☐ ConversionNote: 1202_26.01_18

Date form completed: 6/21/2023

Survey Name: Cranbury Historic Sites Survey Phase III

Surveyor: Spencer Rubino

Organization: Richard Grubb & Associates, Inc.

☒ (Primary Contact)

Property ID:

-1448494467

Page 3

PROPERTY REPORT: PHOTO CONTINUATION SHEET

Property ID: -1448494467

Property Name: 112 North Main Street

Address: 112 N Main ST



Photo 2



Photo 3