

PROPERTY REPORT

Property ID: 1050809850

Property Name: 116 North Main Street
Address: 116 N Main ST

Ownership: Private
Apartment #: **ZIP:** 08512

PROPERTY LOCATION(S):

County:	Municipality:	Local Place Name:	USGS Quad:	Block:	Lot:
MIDDLESEX	Cranbury township	Cranbury	Hightstown	26.01	20

Property Photo:



Old HSI Number:

NRIS Number:

HABS/HAER Number:

Description:

116 North Main Street is a one-story-tall, three-bay-wide, two-bay-deep, frame dwelling constructed circa 1950 in the Minimal Traditional style. The dwelling consists of an L-shaped, cross-gabled main block with a one-story, side-gabled, northeast wing (originally an attached garage), and a one-story, hipped-roof wing to the rear (southeast). Asphalt shingles cover the roof throughout. The roof is accented by overhanging eaves, and a small vinyl cupola with louvered vents sits atop the roof ridge of the northeast addition. An interior, concrete block chimney pierces the rear (southeast) roof slope of the northeast wing. The exterior of the dwelling is clad in vinyl siding. Windows are all single and paired, six-over-six or eight-over-eight, vinyl-sash replacement units. Inoperable, vinyl louvered shutters flank the windows on the primary (northwest) and southwest elevations. The primary elevation has asymmetrical fenestration. The dwelling features two entrances, with one located in the southernmost bay of the northeast wing and the other on the northeast elevation of the main block's front-gabled projection. Both entrances contain modern wood panel doors with a central light. A shed-roof extension shelters the entrance on the northeast wing. The northeast and southwest elevation have asymmetrical fenestration. The northeast elevation of the wing is devoid of openings. The rear elevation and rear wing are not visible from the public right-of-way.

A one-story-tall, front-gabled, frame garage, built circa 1950, stands approximately 60 feet east of the dwelling. It is clad in aluminum siding and the roof is sheathed in asphalt shingles. The primary (northwest) elevation contains an off-center, vinyl panel, roll-top door. The southwest, northeast, and rear (southeast) elevations are not visible from the public right-of-way.

History: 116 North Main Street was constructed circa 1950 and is an example of a mid-twentieth-century, Minimal Traditional-style dwelling in Cranbury. In 1948, the subject property was sold to Frank and Amy Breese, who likely built the dwelling and detached garage shortly thereafter (Middlesex County Clerk's Office 1948 Deed Book 1388:341). Frank was a maintenance carpenter at this time, and Amy was not employed (US Census 1950). The dwelling and garage both appear on a 1953 aerial photograph with their current footprints (Nationwide Environmental Title Research [NETR] 1953). Sometime during the late twentieth or early twenty-first centuries, the extant vinyl siding and vinyl-sash windows were installed. No major alterations occurred to the dwelling during this period (NETR 1979, 1987, 2002). Around 2016, an attached garage adjacent to the northeast elevation of the dwelling was converted into a living space (Google 2013, 2019).

Setting:

Survey Name: Cranbury Historic Sites Survey Phase III

Surveyor: Spencer Rubino

Organization: Richard Grubb & Associates, Inc.

☒ (Primary Contact)

Property ID:

1050809850

Page 1

116 North Main Street is sited on a roughly rectangular-shaped parcel (Block 26.01, Lot 20) located on the southeast side of North Main Street in Cranbury Township, Middlesex County, New Jersey. The dwelling is oriented with its primary elevation facing northwest and is set back approximately 44 feet from the road. An asphalt-paved driveway extends southeast from North Main Street and leads to the northeast wing and detached garage. Mature trees and shrubs are planted within close proximity to the dwelling. The subject dwelling is located in a residential neighborhood surrounded by properties generally dating from the mid-nineteenth to the late twentieth centuries.

**Registration
and Status
Dates:**

National Historic Landmark?: ☐

National Register: 9/18/1980

New Jersey Register: 8/9/1979

Determination of Eligibility: 3/25/1977

Certification of Eligibility:

SHPO Opinion:

Local Designation: 9/26/1988

Other Designation:

Other Designation Date:

☐ **Eligibility Worksheet included in present survey?**

☐ **Is this Property an identifiable farm or former farm?**

Location Map:

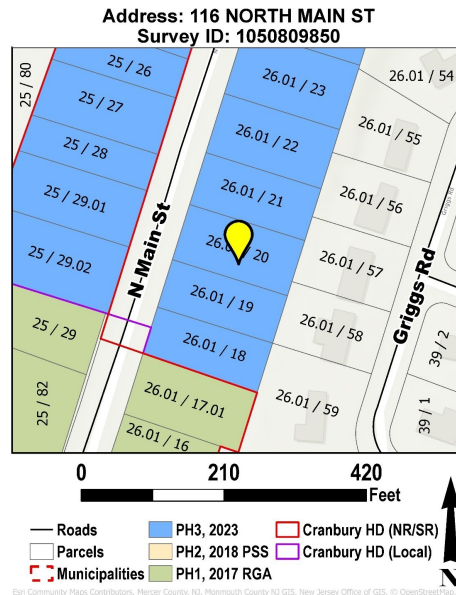

Site Map:



BIBLIOGRAPHY:

Author:	Title:	Year:	HPO Accession #: (if applicable)
Google	Google Street View. Electronic document, https://www.google.com/maps/ , accessed June 2023	2013	
Google	Google Street View. Electronic document, https://www.google.com/maps/ , accessed June 2023	2019	
Heritage Studies	Preserving Historic Cranbury Village. Prepared for the Cranbury Township Historic Preservation Advisory Committee.	1989	
Middlesex County Clerk's Office	On file, Middlesex County Clerk's Office, New Brunswick, New Jersey.		
Nationwide Environmental Title Research (NETR)	Historic Aerial Photograph. Electronic document, https://www.historicaerials.com , accessed May 2023.	1953	
Nationwide Environmental Title Research (NETR)	Historic Aerial Photograph. Electronic document, https://www.historicaerials.com , accessed May 2023.	1979	
Nationwide Environmental Title Research (NETR)	Historic Aerial Photograph. Electronic document, https://www.historicaerials.com , accessed May 2023.	1987	
Nationwide Environmental Title Research (NETR)	Historic Aerial Photograph. Electronic document, https://www.historicaerials.com , accessed May 2023.	2002	
United States Bureau of the Census	Population Schedule, Cranbury Township, Middlesex County, New Jersey.	1950	

Survey Name: Cranbury Historic Sites Survey Phase III

Surveyor: Spencer Rubino

Organization: Richard Grubb & Associates, Inc.

☒ (Primary Contact)

Property ID:

1050809850

Page 2

Additional Information:

Although the dwelling at 116 North Main Street was not identified in the 1980 Cranbury Historic District National Register of Historic Places nomination form, it was evaluated as a non-contributing (intrusion) resource in the 1989 Heritage Studies inventory of the district (Walsh 1980; Heritage Studies 1989). Richard Grubb & Associates, Inc. recommends 116 North Main Street as a non-contributing resource to the Cranbury Historic District due to its date of construction.

More Research Needed? ☐ (checked=Yes)**INTENSIVE-LEVEL USE ONLY:**

Attachments Included:

<input type="checkbox"/> Building	<input type="checkbox"/> Bridge
<input type="checkbox"/> Structure	<input type="checkbox"/> Landscape
<input type="checkbox"/> Object	<input type="checkbox"/> Industry

Historic District ? ☒**District Name:** Cranbury Historic District**Status:** Non Contributing**Associated Archeological Site/Deposits?** ☐

(known or potential sites. If Yes, please describe briefly)

Conversion Problem? ☐ ConversionNote: 1202_26.01_20

Date form completed: 6/21/2023

Survey Name: Cranbury Historic Sites Survey Phase III**Surveyor:** Spencer Rubino**Organization:** Richard Grubb & Associates, Inc.☒ (Primary Contact)**Property ID:****1050809850**

Page 3

PROPERTY REPORT: PHOTO CONTINUATION SHEET

Property ID: 1050809850

Property Name: 116 North Main Street

Address: 116 N Main ST



Photo 2



Photo 3