

# PROPERTY REPORT

Property ID: **-2091715752**

**Property Name:** 118 North Main Street **Ownership:** Private  
**Address:** 118 N Main ST **Apartment #:** **ZIP:** 08512

## PROPERTY LOCATION(S):

County:	Municipality:	Local Place Name:	USGS Quad:	Block:	Lot:
MIDDLESEX	Cranbury township	Cranbury	Hightstown	26.01	21

## Property Photo:



**Old HSI Number:**

**NRIS Number:**

**HABS/HAER Number:**

## Description:

118 North Main Street is a one-story-tall, three-bay-wide, one-bay-deep, brick dwelling constructed circa 1952 in the Minimal Traditional style. The dwelling consists of a cross-gabled main block with a one-story, gable-roof addition on the rear (southeast) elevation (added circa 1960) and a one-story, cross-gabled addition on the northeast elevation (added circa 1960) that connects to a circa-1952, front-gabled garage. Asphalt shingles cover the roof throughout. An exterior, concrete block chimney is located at the southwest gable end of the main block. The exterior of the dwelling is clad in brick laid in running bond, with vinyl siding in the gable ends, on the northeast addition, and on the northeast and southwest elevations. Windows throughout are generally six-over-six or ten-over-ten, vinyl-sash replacement units with inoperable, vinyl louvered shutters flanking the windows on the primary (northwest) elevation. The recessed, primary entrance, centered on the main block, contains a paneled vinyl door with a central light and a glazed metal storm door. The northeast and southwest elevations of the main block have asymmetrical fenestration. The northeast addition contains a secondary entrance with a paneled vinyl door with a single light beside a vinyl-sash window. The garage contains a vinyl panel and roll-top door. The southwest elevation of the rear addition has symmetrical fenestration. The rear elevation of the dwelling is not visible from the public right-of-way.

A modern frame shed stands in the southeast corner of the property.

History: 118 North Main Street, constructed circa 1952, is an example of a mid-twentieth-century, Minimal Traditional-style dwelling in Cranbury, and is an example of a mid-twentieth- In 1951, the subject property was purchased by Philip L. and Sally B. Strong as an empty lot (Middlesex County Clerk's Office 1951 Deed Book 1588:515). Philip Strong was employed as a lawyer and married Sally in the same year they purchased the subject property (United States Bureau of the Census 1950). The subject dwelling was likely built for the Strongs shortly after their 1951 purchase. It first appears on a 1953 aerial photograph, which depicts the main block and a garage to the northeast (Nationwide Environmental Title Research [NETR] 1947, 1953). Around 1960, a gable-roof addition was built on the dwelling's rear elevation, and a connecting addition was built between the northeast elevation of the dwelling's main block and the garage (NETR 1957, 1963). The dwelling underwent little to no alterations through the late twentieth century (NETR 1979, 1987, 2002). Sometime during the late twentieth or early twenty-first centuries, the extant vinyl siding and vinyl-sash windows were installed, and a frame shed was built in the southeast corner of the property.

## Setting:

**Survey Name:** Cranbury Historic Sites Survey Phase III

**Surveyor:** Spencer Rubino

**Organization:** Richard Grubb & Associates, Inc.

(Primary Contact)

**Property ID:**

**-2091715752**

Page 1

118 North Main Street is sited on a roughly rectangular-shaped parcel (Block 26.01, Lot 21) located on the southeast side of North Main Street in Cranbury Township, Middlesex County, New Jersey. The dwelling is oriented with its primary elevation facing northwest and is set back approximately 47 feet from the road. An asphalt-paved driveway extends southeast from North Main Street and leads to the attached garage. Mature trees and shrubs are planted within close proximity to the dwelling. The subject dwelling is located in a residential neighborhood surrounded by properties generally dating from the mid-nineteenth to the late twentieth centuries.

**Registration and Status Dates:**

**National Historic Landmark?:**   
**National Register:** 9/18/1980  
**New Jersey Register:** 8/9/1979  
**Determination of Eligibility:** 3/25/1977  
**Certification of Eligibility:**

**SHPO Opinion:**  
**Local Designation:** 9/26/1988  
**Other Designation:**  
**Other Designation Date:**

Eligibility Worksheet included in present survey?  Is this Property an identifiable farm or former farm?

**Location Map:**

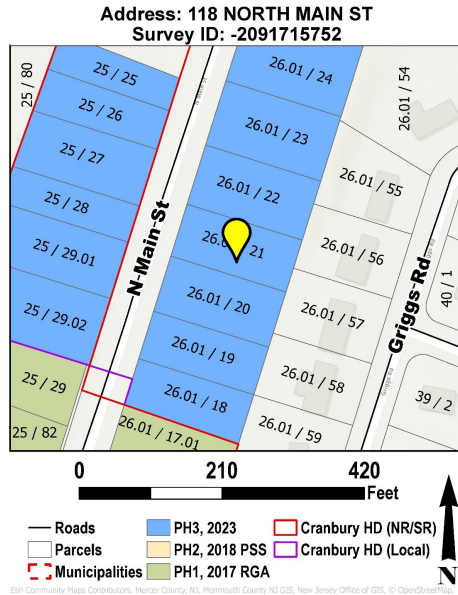

**Site Map:**



**BIBLIOGRAPHY:**

Author:	Title:	Year:	HPO Accession #:	(if applicable)
Google	Google Maps. Electronic document, <a href="https://www.google.com/maps/">https://www.google.com/maps/</a> , accessed June 2023.	2023		
Heritage Studies	Preserving Historic Cranbury Village. Prepared for the Cranbury Township Historic Preservation Advisory Committee.	1989		
Middlesex County Clerk's Office [MCCO]	On file, Middlesex County Clerk's Office, New Brunswick, New Jersey.			
Nationwide Environmental Title Research (NETR)	Historic Aerial Photograph. Electronic document, <a href="https://www.historicaerials.com">https://www.historicaerials.com</a> , accessed May 2023.	1947		
Nationwide Environmental Title Research (NETR)	Historic Aerial Photograph. Electronic document, <a href="https://www.historicaerials.com">https://www.historicaerials.com</a> , accessed May 2023.	1953		
Nationwide Environmental Title Research (NETR)	Historic Aerial Photograph. Electronic document, <a href="https://www.historicaerials.com">https://www.historicaerials.com</a> , accessed May 2023.	1957		
Nationwide Environmental Title Research (NETR)	Historic Aerial Photograph. Electronic document, <a href="https://www.historicaerials.com">https://www.historicaerials.com</a> , accessed May 2023.	1963		
Nationwide Environmental Title Research (NETR)	Historic Aerial Photograph. Electronic document, <a href="https://www.historicaerials.com">https://www.historicaerials.com</a> , accessed May 2023.	1979		
Nationwide Environmental Title Research (NETR)	Historic Aerial Photograph. Electronic document, <a href="https://www.historicaerials.com">https://www.historicaerials.com</a> , accessed May 2023.	1987		

**Survey Name:** Cranbury Historic Sites Survey Phase III

**Surveyor:** Spencer Rubino

**Organization:** Richard Grubb & Associates, Inc.

(Primary Contact)

**Property ID:**

**-2091715752**

Page 2

Research (NETR)		
Nationwide Environmental Title Research (NETR)	Historic Aerial Photograph. Electronic document, https://www.historicaerials.com, accessed May 2023.	2002
United States Bureau of the Census	Population Schedule, City of New Brunswick, Middlesex County, New Jersey.	1950
Walsh, Ruth	National Register of Historic Places Nomination Form for the Cranbury Historic District, Township of Cranbury, Middlesex County, New Jersey. On file, New Jersey Historic Preservation Office, Trenton, New Jersey.	1980

**Additional Information:**

Although the dwelling at 118 North Main Street was identified in the 1980 Cranbury Historic District National Register of Historic Places nomination, it was evaluated as a non-contributing (intrusion) resource in the 1989 Heritage Studies inventory of the district (Walsh 1980; Heritage Studies 1989). Richard Grubb & Associates, Inc. recommends 118 North Main Street as a non-contributing resource to the Cranbury Historic District due to its date of construction.

**More Research Needed?**  (checked=Yes)

**INTENSIVE-LEVEL USE ONLY:**

**Attachments Included:**

0 Building	0 Bridge
0 Structure	0 Landscape
0 Object	0 Industry

**Historic District ?**

**District Name:** Cranbury Historic District

**Status:** Non Contributing

**Associated Archeological Site/Deposits?**

(known or potential sites. If Yes, please describe briefly)

Conversion Problem?  ConversionNote: 1202\_26.01\_21

Date form completed: 6/21/2023

**Survey Name:** Cranbury Historic Sites Survey Phase III

**Surveyor:** Spencer Rubino

**Organization:** Richard Grubb & Associates, Inc.

(Primary Contact)

**Property ID:**

**-2091715752**

Page 3

**PROPERTY REPORT: PHOTO CONTINUATION SHEET**

Property ID: **-2091715752**

**Property Name:** 118 North Main Street

**Address:** 118 N Main ST



*Photo 2*



*Photo 3*