

## PROPERTY REPORT

Property ID: 2006279157

**Property Name:** 138 North Main Street

**Ownership:** Private

**Address:** 138 N Main ST

**Apartment #:**

**ZIP:** 08512

### PROPERTY LOCATION(S):

County:	Municipality:	Local Place Name:	USGS Quad:	Block:	Lot:
MIDDLESEX	Cranbury township	Cranbury	Hightstown	26.01	26

### Property Photo:



**Old HSI Number:**

**NRIS Number:**

**HABS/HAER Number:**

### Description:

138 North Main Street is a one-story-tall, five-bay-wide, frame, Ranch dwelling constructed circa 1960. The dwelling consists of an L-shaped, cross-gabled main block with a one-story, gable-roof addition extending to the rear (southeast) (added circa 1975). The roof is sheathed in asphalt shingles throughout, with overhanging eaves on the main block. An interior brick chimney pierces the roof of the main block near the junction of the cross gables, and a smaller, exterior brick chimney abuts the southwest gable end of the main block. A small wood cupola sits on the roof ridge of the main block's projecting ell. The exterior of the dwelling is primarily clad in wood board and batten siding, with brick laid in running bond on the lower half of the primary (northwest) elevation and wood clapboard siding in the southwest gable end. Windows are generally single and grouped, six-over-six, vinyl-sash replacement units, with inoperable, louvered vinyl shutters flanking the windows on the primary, northeast, and southwest elevations. The central, primary entrance contains a paneled, wood door (with a metal storm door). The entrance is sheltered by a shed-roof porch within the ell, supported by metal posts with a brick stoop and metal railings. The southwestern bays of the primary elevation, on the projecting ell, contain two paneled wood, roll-top doors (likely original). A secondary entrance with a storm door is present on the southwest elevation of the main block but is obscured by vegetation. The rear addition contains an additional entrance in the westernmost bay. The rear elevation is not visible from the public right-of-way.

**History:** 138 North Main Street was constructed circa 1960 and is an example of a mid-twentieth-century Ranch dwelling in Cranbury. In 1958, Robert F. and Wilma L. Shimer purchased a roughly one-half-acre parcel on the east side of North Main Street (Middlesex County Clerk's Office 1958 Deed Book 2034:353). The subject dwelling was likely built two years after the Shimers' purchase and first appears on a 1963 aerial photograph as an L-shaped Ranch dwelling (Nationwide Environmental Title Research [NETR] 1957, 1963). Around 1975, a one-story addition was constructed on the rear elevation of the subject dwelling (NETR 1970, 1979). With the exception of the replacement of the windows, the subject dwelling underwent little to no alterations during the late twentieth and early twenty-first centuries.

### Setting:

138 North Main Street is sited on a roughly rectangular-shaped parcel (Block 26.01, Lot 26) located on the southeast side of North Main Street in Cranbury Township, Middlesex County, New Jersey. The dwelling is oriented with its primary elevation facing northwest and is set back approximately 85 feet from the road. An asphalt-paved driveway extends east from Main Street and terminates at the garage bays of the dwelling. Mature trees and shrubs are planted within close proximity to the dwelling. The subject dwelling is located in a residential neighborhood surrounded by properties generally dating from the mid-nineteenth to the late twentieth centuries.

**Survey Name:** Cranbury Historic Sites Survey Phase III

**Surveyor:** Spencer Rubino

**Organization:** Richard Grubb & Associates, Inc.

☒ (Primary Contact)

**Property ID:**

2006279157

Page 1

**Registration  
and Status  
Dates:**

National Historic Landmark?: ☐

National Register: 9/18/1980

New Jersey Register: 8/9/1979

Determination of Eligibility: 3/25/1977

Certification of Eligibility:

SHPO Opinion:

Local Designation: 9/26/1988

Other Designation:

Other Designation Date:

☐ Eligibility Worksheet included in present survey?

☐ Is this Property an identifiable farm or former farm?

**Location Map:**

**Site Map:**

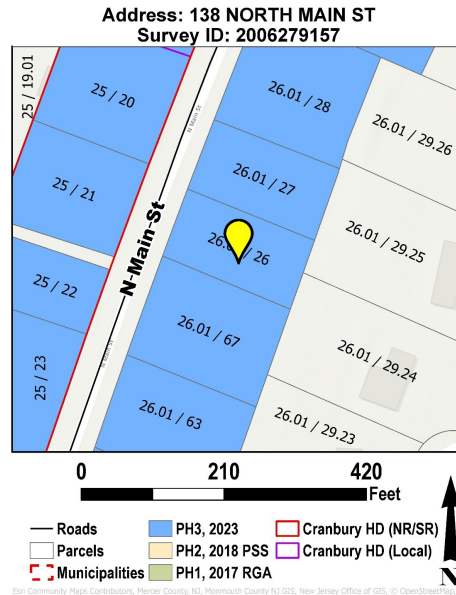

**BIBLIOGRAPHY:**

Author:	Title:	Year:	HPO Accession #: (if applicable)
Heritage Studies	Living Historic Cranbury Village. Prepared for the Cranbury Township Historic Preservation Advisory Committee. On file, New Jersey Historic Preservation Office, Trenton, New Jersey.	1989	
Middlesex County Clerk's Office	On file, Middlesex County Clerk's Office, New Brunswick, New Jersey.		
Nationwide Environmental Title Research (NETR)	Historic Aerial Photograph. Electronic document, <a href="https://www.historicaerials.com">https://www.historicaerials.com</a> , accessed April 2023.	1960	
Nationwide Environmental Title Research (NETR)	Historic Aerial Photograph. Electronic document, <a href="https://www.historicaerials.com">https://www.historicaerials.com</a> , accessed April 2023.	1963	
Nationwide Environmental Title Research (NETR)	Historic Aerial Photograph. Electronic document, <a href="https://www.historicaerials.com">https://www.historicaerials.com</a> , accessed April 2023.	1970	
Nationwide Environmental Title Research (NETR)	Historic Aerial Photograph. Electronic document, <a href="https://www.historicaerials.com">https://www.historicaerials.com</a> , accessed April 2023.	1979	
Walsh, Ruth	National Register of Historic Places Nomination, Cranbury Historic District, Cranbury Township, Middlesex County, New Jersey. On file, New Jersey Historic Preservation Office, Cranbury, New Jersey.	1980	

**Additional Information:**

Although the dwelling at 138 North Main Street was not identified in the 1980 Cranbury Historic District National Register of Historic Places nomination, it was identified in the 1989 Heritage Studies inventory of the district as a non-contributing (harmonious) resource (Walsh 1980; Heritage Studies 1989). Richard Grubb & Associates, Inc. recommends the subject dwelling as a non-contributing resource to the Cranbury Historic District due to its date of construction.

**More Research Needed?** ☐ (checked=Yes)

**Survey Name:** Cranbury Historic Sites Survey Phase III

**Surveyor:** Spencer Rubino

**Organization:** Richard Grubb & Associates, Inc.

☒ (Primary Contact)

**Property ID:**

2006279157

Page 2

**INTENSIVE-LEVEL USE ONLY:**

**Attachments Included:**

0 Building  
0 Structure  
0 Object

0 Bridge  
0 Landscape  
0 Industry

**Historic District ?** ☒

**District Name:** Cranbury Historic District

**Status:** Non Contributing

**Associated Archeological Site/Deposits?** ☐

(known or potential sites. If Yes, please describe briefly)

---

Conversion Problem? ☐ ConversionNote: 1202\_26.01\_26

Date form completed: 6/21/2023

---

**Survey Name:** Cranbury Historic Sites Survey Phase III

**Surveyor:** Spencer Rubino

**Organization:** Richard Grubb & Associates, Inc.

☒ (Primary Contact)

**Property ID:**

**2006279157**

Page 3



**PROPERTY REPORT: PHOTO CONTINUATION SHEET**

Property ID: 2006279157

**Property Name:** 138 North Main Street

**Address:** 138 N Main ST



*Photo 2*



*Photo 3*