

PROPERTY REPORT

Property ID: 351760176

Property Name: 128 North Main Street
Address: 128 N Main ST

Ownership: Private
Apartment #: **ZIP:** 08512

PROPERTY LOCATION(S):

County:	Municipality:	Local Place Name:	USGS Quad:	Block:	Lot:
MIDDLESEX	Cranbury township	Cranbury	Hightstown	26.01	63

Property Photo:



Old HSI Number:

NRIS Number:

HABS/HAER Number:

Description:

128 North Main Street is a two-story-tall, three-bay-wide, two-bay-deep, frame dwelling constructed circa 1958. The dwelling consists of a side-gabled main block with a one-story, side-gabled, southwest wing, and a one-story, side-gabled, northeast wing. The roof throughout is covered by asphalt shingles and accented by overhanging eaves. Exterior brick chimneys are centered on the northeast elevation of the main block and the southwest elevation of the southwest wing. The exterior of the dwelling is clad in vinyl siding. Windows are all six-over-six or eight-over-eight, vinyl-sash, replacement units. Inoperable, vinyl louvered shutters flank the windows on the primary (northwest) and southeast elevations of the main block and southwest wing. Located in the center bay of the main block, the primary entrance contains a paneled wood door with a single rectangular light. A one-story, shed-roof porch shelters the two southernmost bays of the main block, supported by square, wood posts. Fenestration on the northeast elevation of the main block and the northeast wing are obscured by coniferous trees. The southwest wing has symmetrical fenestration on the primary and southeast elevations. A walkway covered by a gable roof connects the rear (southeast) elevation of the wing to a circa-1965 garage. The rear elevation of the dwelling was not visible from the public right-of-way.

A one-story-tall, two-bay-wide, frame garage, built circa 1965, sits approximately 8 feet southeast of the dwelling, connected by a covered walkway. The side-gabled roof is clad in asphalt shingles and accented by overhanging eaves. Vertical wood paneling covers the exterior. The primary (southwest) elevation contains two vinyl paneled, roll-top garage doors. The rear (northeast) and the southeast elevations are not visible from the public right-of-way.

History: 128 North Main Street was constructed circa 1958 and is an example of a mid-twentieth-century dwelling in Cranbury. In 1958, Charles T. and Jane M. Waters purchased the subject property from John W. Bruce, Jr. and his wife, Edna, as an empty lot (Middlesex County Clerk's Office 1958 Deed Book 2035:404). The Waters family build the subject dwelling shortly after their purchase (Cranbury Historic Preservation Commission 2023). The dwelling first appears on a 1963 aerial photograph in nearly its current footprint (Nationwide Environmental Title Research [NETR] 1963). Around 1965, a frame garage was constructed southeast of the dwelling, connected by a covered walkway (NETR 1963, 1969). The subject dwelling has undergone minimal changes during the late twentieth and early twenty-first centuries.

Setting:

Survey Name: Cranbury Historic Sites Survey Phase III

Surveyor: Spencer Rubino

Organization: Richard Grubb & Associates, Inc.

☒ (Primary Contact)

Property ID:

351760176

Page 1

128 North Main Street is sited on a roughly rectangular-shaped parcel (Block 26.01, Lot 63) located on the southeast side of North Main Street in Cranbury Township, Middlesex County, New Jersey. The dwelling is oriented with its primary elevation facing northwest and is set back approximately 85 feet from the road. An asphalt-paved driveway extends east from Main Street and travels along the southwest border of the parcel to the garage. Mature trees and shrubs are planted within close proximity to the dwelling. The subject dwelling is located in a residential neighborhood surrounded by properties generally dating from the mid-nineteenth to the late twentieth centuries.

**Registration
and Status
Dates:**

National Historic Landmark?: ☐

National Register: 9/18/1980

New Jersey Register: 8/9/1979

Determination of Eligibility: 3/25/1977

Certification of Eligibility:

SHPO Opinion:

Local Designation: 9/26/1988

Other Designation:

Other Designation Date:

☐ **Eligibility Worksheet included in present survey?**

☐ **Is this Property an identifiable farm or former farm?**

Location Map:

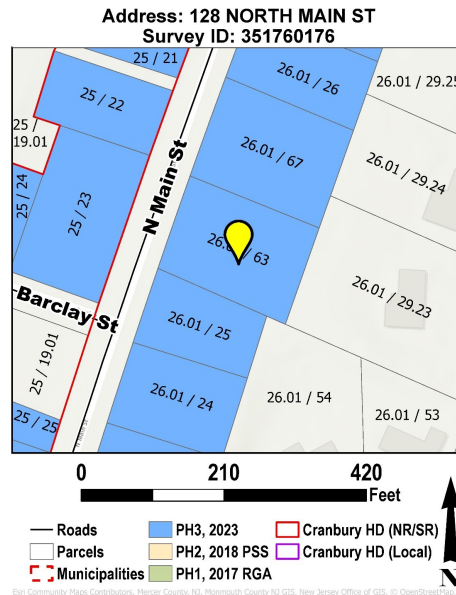

Site Map:

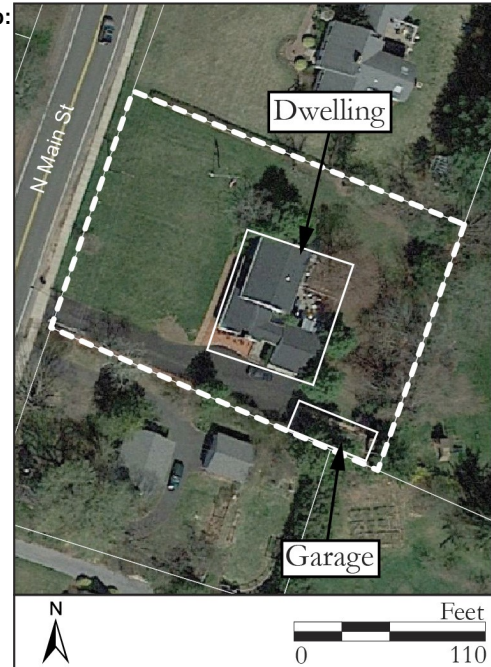

BIBLIOGRAPHY:

Author:	Title:	Year:	HPO Accession #: (if applicable)
Cranbury Historic Preservation Commission	Meeting with the Cranbury Historic Preservation Commission, August 1, 2023.	2023	
Middlesex County Clerk's Office [MCCO]	On file, Middlesex County Clerk's Office, New Brunswick, New Jersey.		
Nationwide Environmental Title Research (NETR)	Historic Aerial Photograph. Electronic document, https://www.historicaerials.com , accessed April 2023.	1963	
Nationwide Environmental Title Research (NETR)	Historic Aerial Photograph. Electronic document, https://www.historicaerials.com , accessed April 2023.	1969	

Additional Information:

Richard Grubb & Associates, Inc. recommends 128 North Main Street as a non-contributing resource to the Cranbury Historic District due to its date of construction.

More Research Needed? ☐ (checked=Yes)

INTENSIVE-LEVEL USE ONLY:

Attachments Included:

0 Building	0 Bridge
0 Structure	0 Landscape
0 Object	0 Industry

Historic District ? ☒

District Name: Cranbury Historic District

Survey Name: Cranbury Historic Sites Survey Phase III

Surveyor: Spencer Rubino

Organization: Richard Grubb & Associates, Inc.

Property ID:

☒ (Primary Contact)

351760176

Page 2

Status: Non Contributing

Associated Archeological Site/Deposits?

☐

(known or potential sites. If Yes, please describe briefly)

Conversion Problem? ☐

ConversionNote: 1202_26.01_63

Date form completed: 6/21/2023

Survey Name: Cranbury Historic Sites Survey Phase III

Surveyor: Spencer Rubino

Organization: Richard Grubb & Associates, Inc.

☒ (Primary Contact)

Property ID:

351760176

Page 3

PROPERTY REPORT: PHOTO CONTINUATION SHEET

Property ID: 351760176

Property Name: 128 North Main Street

Address: 128 N Main ST



Photo 2



Photo 3