

PROPERTY REPORT

Property ID: -1062717435

Property Name: 103 Plainsboro Road

Ownership: Private

Address: 103 Plainsboro RD

Apartment #:

ZIP: 08512

PROPERTY LOCATION(S):

County:	Municipality:	Local Place Name:	USGS Quad:	Block:	Lot:
MIDDLESEX	Cranbury township	Cranbury	Hightstown	28	17

Property Photo:



Old HSI Number:

NRIS Number:

HABS/HAER Number:

Description:

103 Plainsboro Road is a two-and-one-half-story-tall, three-bay-wide, frame dwelling constructed in 2015. The dwelling consists of a cross-gabled main block with a projecting front-gabled wing that contains a garage on the primary (northeast) elevation. Two gabled dormers interrupt the northeast roof slope of the main block. Asphalt shingles cover the roof throughout. The dwelling's exterior is clad in vinyl siding, and windows are all single or paired, six-over-six, vinyl-sash units. Some of the windows on the primary elevation are flanked by inoperable, vinyl paneled shutters. A pair of fixed vinyl windows are centered on the second floor. Located in the center bay, the primary entrance is sheltered by a shed-roof porch with a gable emphasizing the entrance bay, supported by vinyl, Doric columns with a plain vinyl balustrade. The entrance contains a paneled wood door. The front-gabled wing projects from the northwestern bay of the primary elevation and features a paneled, roll-top garage door with faux strap hinges on the first floor. The northwest and southeast elevations have asymmetrical fenestration with single or paired vinyl-sash windows. The rear (southwest) elevation was not visible from the public right-of-way. The dwelling on a concrete foundation faced in quarried stone.

History: 103 Plainsboro Road is an example of a twenty-first-century contemporary dwelling in Cranbury. The dwelling was constructed by Woodbrook Homes LLC in 2015, replacing a small, one-story, frame, early twentieth-century cottage (Middlesex County Clerk's Office 2015 Deed Book 6779:179; Nationwide Environmental Title Research 2013, 2015; Google 2013). Since its construction, the subject dwelling has undergone minimal exterior changes.

Setting:

103 Plainsboro Road is sited on a roughly rectangular-shaped parcel (Block 28, Lot 17) located on the southwest side of Plainsboro Road in Cranbury Township, Middlesex County, New Jersey. The dwelling is oriented with its primary elevation facing northeast and is set back approximately 20 feet from the road. A paved driveway extends south from Plainsboro Road and leads to the incorporated garage. Mature trees and shrubs are planted within close proximity to the dwelling. The subject dwelling is located in a residential neighborhood surrounded by properties generally dating from the mid-nineteenth to the late twentieth centuries.

Survey Name: Cranbury Historic Sites Survey Phase III

Surveyor: Spencer Rubino

Organization: Richard Grubb & Associates, Inc.

☒ (Primary Contact)

Property ID:

-1062717435

Page 1

Registration
and Status
Dates:

National Historic Landmark?: ☐

National Register: 9/18/1980

New Jersey Register: 8/9/1979

Determination of Eligibility: 3/25/1977

Certification of Eligibility:

SHPO Opinion:

Local Designation: 9/26/1988

Other Designation:

Other Designation Date:

☐ Eligibility Worksheet included in present survey?

☐ Is this Property an identifiable farm or former farm?

Location Map:

Site Map:

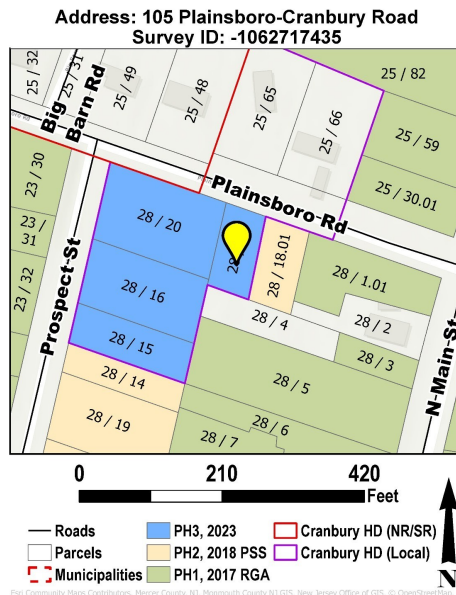

BIBLIOGRAPHY:

Author:	Title:	Year:	HPO Accession #: (if applicable)
Google	Google Street View, September 2013. Electronic document, www.google.com/maps , accessed May 2023.	2013	
Middlesex County Clerk's Office	On file, Middlesex County Clerk's Office, New Brunswick, New Jersey.		
Nationwide Environmental Title Research	Historic Aerial Photograph. Electronic document, www.historicaerials.com , accessed May 2023.	2013	
Nationwide Environmental Title Research	Historic Aerial Photograph. Electronic document, www.historicaerials.com , accessed May 2023.	2015	

Additional Information:

Richard Grubb & Associates, Inc. recommends 103 Plainsboro Road as a non-contributing resource to the Cranbury Historic District due to its date of construction.

More Research Needed? ☐ (checked=Yes)

INTENSIVE-LEVEL USE ONLY:

Attachments Included:

0 Building	0 Bridge
0 Structure	0 Landscape
0 Object	0 Industry

Historic District ? ☒

District Name: Cranbury Historic District

Status: Non Contributing

Associated Archeological Site/Deposits? ☐

(known or potential sites. If Yes, please describe briefly)

Survey Name: Cranbury Historic Sites Survey Phase III

Surveyor: Spencer Rubino

Organization: Richard Grubb & Associates, Inc.

☒ (Primary Contact)

Property ID:

-1062717435

Page 2

Conversion Problem? ☐ ConversionNote: 1202_28_17

Date form completed: 6/21/2023

Survey Name: Cranbury Historic Sites Survey Phase III

Surveyor: Spencer Rubino

Organization: Richard Grubb & Associates, Inc.

☒ (Primary Contact)

Property ID:

-1062717435

Page 3

PROPERTY REPORT: PHOTO CONTINUATION SHEET

Property ID: -1062717435

Property Name: 103 Plainsboro Road

Address: 103 Plainsboro RD



Photo 2



Photo 3