

## PROPERTY REPORT

Property ID: -801080422

**Property Name:** 18 Prospect Street  
**Address:** 18 Prospect ST

**Ownership:** Private  
**Apartment #:**  
**ZIP:** 08512

### PROPERTY LOCATION(S):

County:	Municipality:	Local Place Name:	USGS Quad:	Block:	Lot:
MIDDLESEX	Cranbury township	Cranbury	Hightstown	28	20

### Property Photo:



**Old HSI Number:**

**NRIS Number:**

**HABS/HAER Number:**

### Description:

18 Prospect Street is a two-story-tall, four-bay-wide, frame, Tri-Level Split dwelling constructed circa 1964. The dwelling consists of a side-gabled main block and a one-story, gabled wing on the rear (southeast) elevation. Asphalt shingles cover the roof throughout. Exterior brick chimneys are located at the southwest and northeast gable ends of the main block. The dwelling's exterior is clad in vinyl siding, and windows are primarily single or grouped, six-over-six, vinyl-sash replacement units, set within wood frames. Inoperable, vinyl louvered shutters flank the windows on the primary (northwest) and northeast elevations. A vinyl picture window is located in the southernmost bay of the main block's primary elevation and a one-story, three-bay-wide, shed-roof porch extends along the northernmost bays. The primary entrance is located in the second southernmost bay and contains a nine-light, paneled wood door with a glazed storm door. The northeast elevation of the main block contains an asymmetrical fenestration, and the southwest elevation is devoid of openings. The rear elevation is largely obscured by the one-story rear wing. The rear wing contains two six-over-six, double-hung, wood-sash windows (likely original) flanked by inoperable vinyl louvered shutters on the northeast elevation. The southwest elevation is not visible from the public right-of-way. The dwelling stands on a concrete foundation.

A modern frame shed stands southeast of the dwelling.

**History:** 18 Prospect Street is an example of a mid-twentieth-century, Tri-Level Split dwelling in Cranbury. The dwelling was constructed by Barry Builders Inc. around 1964 (Nationwide Environmental Title Research [NETR] 1963; Middlesex County Clerk's Office [MCCO] 1964 Deed Book 2518:504). Barry Builders Inc. was a Cranbury-based construction company that built several dwellings along Prospect Street and North Main Street during the mid-twentieth century (The Central New Jersey Home News, 4 December 1960:46). In 1965, the company sold the subject dwelling to John and Ruth Cook (MCCO 1965 Deed Book 2518:504). The subject dwelling first appears in a 1969 aerial photograph, depicting its current footprint (NETR 1969). No major alterations have occurred to the subject dwelling since its construction (NETR 1979, 1987, 2002, 2019).

### Setting:

18 Prospect Street is sited on a rectangular-shaped parcel (Block 28, Lot 20) at the southeast corner of Prospect Street and Plainsboro Road in Cranbury Township, Middlesex County, New Jersey. The dwelling is oriented with its primary elevation facing northwest and is set back approximately 75 feet from the road. A paved driveway extends east from Prospect Street and wraps around to the rear of the

**Survey Name:** Cranbury Historic Sites Survey Phase III

**Surveyor:** Spencer Rubino

**Organization:** Richard Grubb & Associates, Inc.

☒ (Primary Contact)

**Property ID:**

-801080422

Page 1

dwelling. Mature trees and shrubs are planted within close proximity to the dwelling. The subject dwelling is located in a residential neighborhood surrounded by properties generally dating from the mid-nineteenth to the late twentieth centuries.

**Registration  
and Status  
Dates:**

**National Historic Landmark?:** ☐

**National Register:** 9/18/1980

**New Jersey Register:** 8/9/1979

**Determination of Eligibility:** 3/25/1977

**Certification of Eligibility:**

**SHPO Opinion:**

**Local Designation:** 9/26/1988

**Other Designation:**

**Other Designation Date:**

☐ **Eligibility Worksheet included in present survey?**

☐ **Is this Property an identifiable farm or former farm?**

**Location Map:**

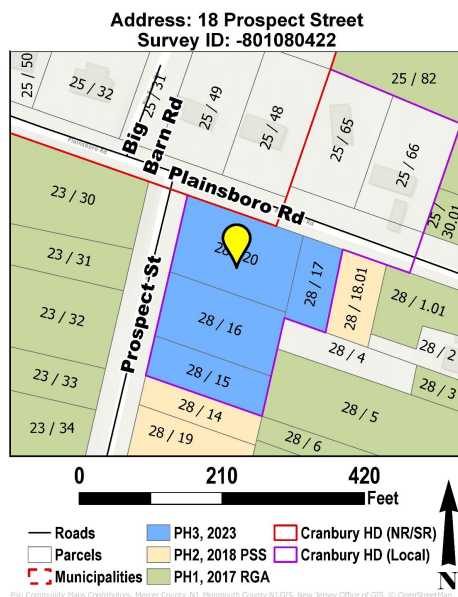

**Site Map:**

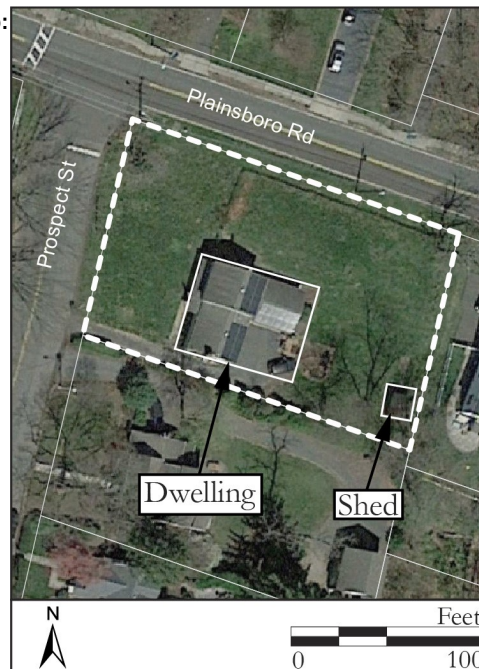

**BIBLIOGRAPHY:**

Author:	Title:	Year:	HPO Accession #: (if applicable)
The Central New Jersey Home News	Barry Builders Inc. 4 December:46. New Brunswick, New Jersey.	1960	
Middlesex County Clerk's Office [MCCO]	On file, Middlesex County Clerk's Office, New Brunswick, New Jersey.		
Nationwide Environmental Title Research (NETR)	Historic Aerial Photograph. Electronic document, <a href="https://www.historicaerials.com">https://www.historicaerials.com</a> , accessed May 2023.	1963	
Nationwide Environmental Title Research (NETR)	Historic Aerial Photograph. Electronic document, <a href="https://www.historicaerials.com">https://www.historicaerials.com</a> , accessed May 2023.	1969	
Nationwide Environmental Title Research (NETR)	Historic Aerial Photograph. Electronic document, <a href="https://www.historicaerials.com">https://www.historicaerials.com</a> , accessed May 2023.	1970	
Nationwide Environmental Title Research (NETR)	Historic Aerial Photograph. Electronic document, <a href="https://www.historicaerials.com">https://www.historicaerials.com</a> , accessed May 2023.	1979	
Nationwide Environmental Title Research (NETR)	Historic Aerial Photograph. Electronic document, <a href="https://www.historicaerials.com">https://www.historicaerials.com</a> , accessed May 2023.	1987	
Nationwide Environmental Title Research (NETR)	Historic Aerial Photograph. Electronic document, <a href="https://www.historicaerials.com">https://www.historicaerials.com</a> , accessed May 2023.	2002	
Nationwide Environmental Title Research (NETR)	Historic Aerial Photograph. Electronic document, <a href="https://www.historicaerials.com">https://www.historicaerials.com</a> , accessed May 2023.	2019	

**Additional Information:**

**Survey Name:** Cranbury Historic Sites Survey Phase III

**Surveyor:** Spencer Rubino

**Organization:** Richard Grubb & Associates, Inc.

☒ (Primary Contact)

**Property ID:**

**-801080422**

Page 2

Richard Grubb & Associates, Inc. recommends 18 Prospect Street as a non-contributing resource to the Cranbury Historic District due to its date of construction.

**More Research Needed?** ☐ (checked=Yes)

---

**INTENSIVE-LEVEL USE ONLY:**

**Attachments Included:**

0	Building	0	Bridge
0	Structure	0	Landscape
0	Object	0	Industry

**Historic District ?** ☒

**District Name:** Cranbury Historic District

**Status:** Non Contributing

**Associated Archeological Site/Deposits?** ☐

(known or potential sites. If Yes, please describe briefly)

---

Conversion Problem? ☐ ConversionNote: 1202\_28\_20

Date form completed: 6/21/2023

---

**Survey Name:** Cranbury Historic Sites Survey Phase III

**Surveyor:** Spencer Rubino

**Organization:** Richard Grubb & Associates, Inc.

☒ (Primary Contact)

**Property ID:**

**-801080422**

Page 3



**PROPERTY REPORT: PHOTO CONTINUATION SHEET**

Property ID: -801080422

**Property Name:** 18 Prospect Street

**Address:** 18 Prospect ST



Photo 2



Photo 3



Property Name: 18 Prospect Street

Address: 18 Prospect ST



Photo 4