

## PROPERTY REPORT

Property ID: 1774282302

**Property Name:** Lewis Stults House  
**Address:** 93 N Main ST

**Ownership:** Private  
**Apartment #:** **ZIP:** 08512

### PROPERTY LOCATION(S):

County:	Municipality:	Local Place Name:	USGS Quad:	Block:	Lot:
MIDDLESEX	Cranbury township	Cranbury	Hightstown	28	6

### Property Photo:



**Old HSI Number:**

**NRIS Number:**

**HABS/HAER Number:**

### Description:

The Lewis Stults House at 93 North Main Street is a complex Queen Anne style residence consisting of a two-and-a-half story, five-bay, two-pile main block, two two-story rear additions, and two-story bays projecting from the southeast and southwest corners. The dwelling dates to circa 1870. The main block has a cross-gabled roof created by a centered gable with a gentle pitched roof, wood shingled walls, and a decorative attic louver. The roof is sheathed with asphalt shingles. Two interior brick chimneys pierce the roof at the gable ends. The thick molded cornice is installed over a wood frieze; it doubles as an interior gutter system and runs along the eaves below the front cross-gable to produce a tympanum appearance. The exterior of the dwelling is clad in wood clapboard siding on the first floor and wood shingles on the second floor. The southeast corner of the house has a projecting squared bay installed at an angle from the wall surface; it has a flared second floor clad with wood shingles over the clapboard-clad first floor. The wider face and the narrower side panels of the bay feature a single one-over-one double hung sash replacement window; the windows on the bay have undersized louvered shutters. Fenestration on the wall surface north of the angled corner bay varies by floor. The second floor has sixteen-over-one wood sash windows with louvered shutters; the center window is a protruding bay with a larger center light flanked by small, multi-light windows (this bay was installed circa 2000). The front porch is a hipped roof element extending over the center three bays. Its roof is clad with asphalt shingles, supported by four Doric columns with overstated capitals and standing on brick piers connected by a simple railing. The central entrance consists of a one-light, two-panel replacement door topped by a rectangular transom with an etched floral design. The house has a stone foundation.

**Survey Name:** Cranbury CLG Survey 2017

**Surveyor:** Kristen Herrick

**Organization:** RGA, Inc.

☒ (Primary Contact)

**Property ID:**

1774282302

Page 1

The south elevation of the house consists of the south end of the main block and the rear ell section. The cladding materials are the same as those on the main elevation: asphalt shingles on the roof and wood clapboard siding. An ancillary porch on the south end of the main block has a hipped roof supported by thin square posts standing on brick piers and connected by a simple railing. The rear addition is a two-story gabled section with the same cladding as the core. Its fenestration consists of single and paired windows. A key feature of the rear addition is its own angled corner bay in the southwest corner of the house with windows repeating the appearance of the corner bay on the main block. The north elevation repeats the cladding of the main elevation (asphalt shingles on the roof and wood clapboard siding). A single rank of replacement windows is located near the northeast corner, and the windows feature louvered shutters. The visible portion of the rear addition has the appearance of a two-story shed-roofed section with the same cladding as the main block, two-over-two wood sash windows on the second floor, and smaller one-over-one replacement windows on the first floor.

Character-defining elements of the dwelling include the cross-gabled roof, front porch, and semi-hexagonal projecting bays with flared eaves.

**History:**

The 1916 Sanborn Atlas shows the house with a rectangular main block, without the corner bay. The front porch is centered on the elevation, and the south porch is also shown. The house had no rear addition. The 1933 Sanborn Atlas shows the corner bay in the southeast corner and the current porch but no rear addition. Both atlases show two outbuildings west of the house. The smaller outbuilding disappears from historic aerial photographs after 1979. The rear addition was constructed by 1957 and extended to the west circa 2007 with the rear corner bay.

**Setting:**

The Lewis Stults House at 93 North Main Street is sited on a rectangular parcel (Block 28, Lot 6) located on the west side of North Main Street in Cranbury Township, Middlesex County, New Jersey. The dwelling is oriented with its primary elevation facing east and is set back approximately 15 feet from North Main Street. A concrete sidewalk spans the east side of the parcel. A paved driveway leads west from North Main Street to a two-story frame outbuilding located west of the dwelling. The property is lightly wooded. The Lewis Stults House at 93 North Main Street is located in a primarily residential neighborhood surrounded by other residential properties dating from the mid-nineteenth to the early twentieth centuries.

**Registration  
and Status  
Dates:**

**National Historic Landmark?:** ☐

**National Register:** 9/18/1980

**New Jersey Register:** 8/9/1979

**Determination of Eligibility:** 3/25/1977

**Certification of Eligibility:**

**SHPO Opinion:**

**Local Designation:** 9/26/1988

**Other Designation:**

**Other Designation Date:**

☐ **Eligibility Worksheet included in present survey?**

☐ **Is this Property an identifiable farm or former farm?**

---

**Survey Name:** Cranbury CLG Survey 2017

**Surveyor:** Kristen Herrick

**Organization:** RGA, Inc.

☒ (Primary Contact)

**Property ID:**

**1774282302**

Page 2

Location Map:

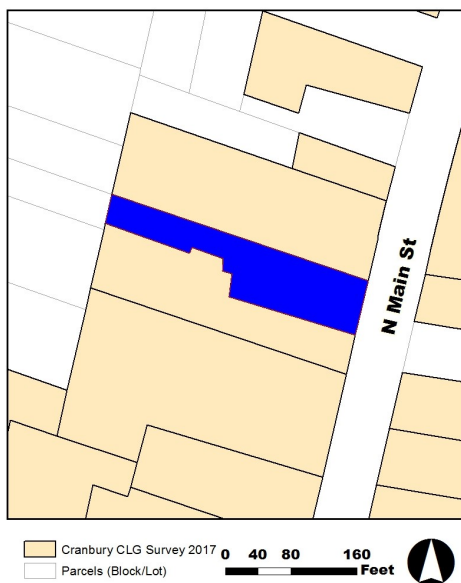

Site Map:



#### BIBLIOGRAPHY:

Author:	Title:	Year:	HPO Accession #:	(if applicable)
Walsh, Ruth	National Register of Historic Places Nomination for the Cranbury Historic District, Cranbury Township, Middlesex County, New Jersey	1979		
Heritage Studies	Preserving Historic Cranbury Village	1989		
Cranbury Historical and Preservation Society	Property File, 93 North Main Street			

#### Additional Information:

The 1989 Heritage Studies survey identified the Lewis Stults House at 93 North Main Street as a contributing resource to the Cranbury Historic District. RGA concurs with the previous evaluation and recommends the Lewis Stults House at 93 North Main Street as a contributing resource due to its date of construction, design, and use of materials compatible with the district.

More Research Needed? ☐ (checked=Yes)

#### INTENSIVE-LEVEL USE ONLY:

Attachments Included: 0 Building 0 Bridge  
0 Structure 0 Landscape  
0 Object 0 Industry

Historic District ? ☒

District Name: Cranbury Historic District

Status: Contributing

Associated Archeological Site/Deposits? ☐

(known or potential sites. If Yes, please describe briefly)

Conversion Problem? ☐ ConversionNote: 51

Survey Name: Cranbury CLG Survey 2017

Surveyor: Kristen Herrick

Organization: RGA, Inc.

Property ID:

Page 3

☒ (Primary Contact)

1774282302

Date form completed: 7/26/2017

---

**Survey Name:** Cranbury CLG Survey 2017

**Surveyor:** Kristen Herrick

**Organization:** RGA, Inc.

☒ (Primary Contact)

**Property ID:**

1774282302

Page 4