

PROPERTY REPORT

Property ID: -977443286

Property Name: 91 North Main Street

Address: 91 N Main ST

Ownership:

Apartment #:

ZIP: 08512

PROPERTY LOCATION(S):

County:	Municipality:	Local Place Name:	USGS Quad:	Block:	Lot:
MIDDLESEX	Cranbury township	Cranbury	Hightstown	28	7

Property Photo:



Old HSI Number:

NRIS Number:

HABS/HAER Number:

Description:

91 North Main Street is a one-and-a-half-story, three-bay, three-pile, frame private residence constructed circa 1935 in a Bungalow form. The dwelling consists of a rectangular main block with multiple additions extending to the west. The side-gabled roof is sheathed with asphalt shingles and features triangular brackets below the overhanging eaves. A gabled dormer on the main (east) slope of the roof features overhanging eaves, wood shingled walls, and a tripartite window unit comprised of replacement six-over-one vinyl sash windows. An exterior brick chimney is located on the north elevation, and an interior brick chimney pierces the roof at the ridge line on one of the rear additions. The exterior of the dwelling is clad in wood shingles. The front porch extends across the entire main elevation; two thick, stubby tapered columns support the eaves and are connected by a half-wall with a centered opening. The central entrance consists of a multi-light replacement French door, flanked by paired six-over-one vinyl-sash (replacement) windows.

The south elevation of the main block repeats the cladding materials of the main elevation: asphalt shingles on the roof and wood shingles on the walls. The triangular brackets are highly visible on this elevation. Fenestration is symmetrically spaced, consisting of replacement six-over-one vinyl sash units. A paired unit is located in the peak of the gable, and the first floor has a central tripled window flanked by paired windows. The north elevation has the same cladding materials as the main elevation (asphalt shingles on the roof and wood shingled walls). The key feature of the elevation is the attached brick chimney, located slightly east of center. The elevation also has no triangular brackets. Fenestration is less symmetrically spaced on this elevation. The attic level has a paired window unit, and the first floor

Survey Name: Cranbury CLG Survey 2017

Surveyor: Kristen Herrick

Organization: RGA, Inc.

Property ID:

Page 1

☒ (Primary Contact)

-977443286

has a paired unit east of a protruding rectangular bay with a shed roof and a paired window.

The house has a large rear addition in the shape of a Greek cross (constructed circa 2000). The section is barely visible from the public right-of-way. Its cross-gabled roof is clad with asphalt shingles, and its walls are clad with vinyl siding. A few triangular-shaped brackets are located below the slightly extended eaves. Windows are asymmetrically spaced units (likely all dating to the construction of the section). The section has a concrete foundation.

Character-defining elements of the dwelling include a front-gabled dormer and an overhang porch with block piers.

History: The house does not appear on the Sanborn Atlases of 1916 or 1933. It appears on the historic aerial photograph of 1940 without its rear addition, which was constructed circa 2000. The larger outbuilding in the rear of the lot first appears on historic aerial photographs in 1969, and the outbuilding in between was constructed after the historic aerial of 2012.

Setting:

91 North Main Street is sited on a rectangular parcel (Block 28, Lot 7) located on the east side of North Main Street in Cranbury Township, Middlesex County, New Jersey. The dwelling is oriented with its primary elevation facing southeast and is set back approximately 20 feet from North Main Street. A concrete sidewalk spans the east side of the parcel. A loose gravel driveway leads northwest from North Main Street to a two-story barn located west of the subject dwelling. The property is lightly wooded. 91 North Main Street is located in a primarily residential neighborhood surrounded by residential properties dating from the mid-nineteenth to the early twentieth century.

Registration and Status Dates:

National Historic Landmark?: ☐

National Register: 9/18/1980

New Jersey Register: 8/9/1979

Determination of Eligibility: 3/25/1977

Certification of Eligibility:

SHPO Opinion:

Local Designation: 9/26/1988

Other Designation:

Other Designation Date:

☐ Eligibility Worksheet included in present survey?

☐ Is this Property an identifiable farm or former farm?

Location Map:

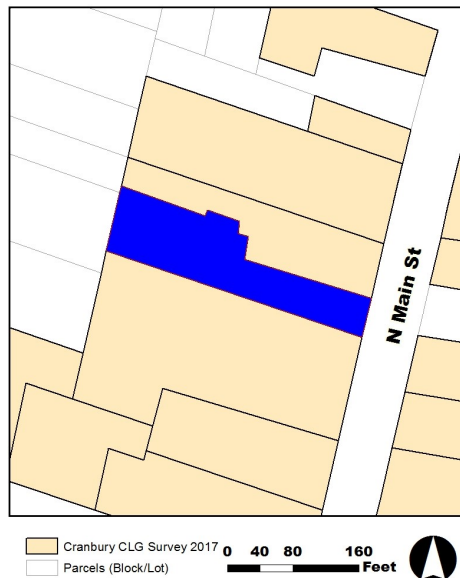

Site Map:

BIBLIOGRAPHY:

Author:	Title:	Year:	HPO Accession #: (if applicable)
Walsh, Ruth	National Register of Historic Places Nomination for the Cranbury Historic District, Cranbury Township, Middlesex County, New Jersey	1979	

Survey Name: Cranbury CLG Survey 2017

Surveyor: Kristen Herrick

Organization: RGA, Inc.

☒ (Primary Contact)

Property ID:

-977443286

Page 2

Additional Information:

The 1989 Heritage Studies survey identified 91 North Main Street as a contributing resource to the Cranbury Historic District. However, a review of historic maps revealed that the subject dwelling was constructed circa 1935, outside of the district's period of significance. Therefore, RGA recommends 91 North Main Street as a non-contributing resource due to its date of construction.

More Research Needed? ☐ (checked=Yes)

INTENSIVE-LEVEL USE ONLY:

Attachments Included:

<input type="checkbox"/> Building	<input type="checkbox"/> Bridge
<input type="checkbox"/> Structure	<input type="checkbox"/> Landscape
<input type="checkbox"/> Object	<input type="checkbox"/> Industry

Historic District ? ☒

District Name: Cranbury Historic District

Status: Non Contributing

Associated Archeological Site/Deposits? ☐

(known or potential sites. If Yes, please describe briefly)

Conversion Problem? ☐ ConversionNote: 55

Date form completed: 7/10/2017

Survey Name: Cranbury CLG Survey 2017

Surveyor: Kristen Herrick

Organization: RGA, Inc.

☒ (Primary Contact)

Property ID:

-977443286

Page 3