

PROPERTY REPORT

Property ID: **-1907133494**

Property Name: John Lewis House

Ownership: Private

Address: 2 N Main ST

Apartment #:

ZIP: 08512

PROPERTY LOCATION(S):

County:	Municipality:	Local Place Name:	USGS Quad:	Block:	Lot:
MIDDLESEX	Cranbury township	Cranbury	Hightstown	33	38

Property Photo:



Old HSI Number:

NRIS Number:

HABS/HAER Number:

Description:

The John Lewis House at 2 North Main Street is a two-story, three-bay, two-pile private residence constructed circa 1850. The house faces west onto North Main Street and has a one-story addition on the south elevation that wraps onto the east (rear) elevation.

The front gabled roof is sheathed with asphalt shingles. The molded raking cornice includes returns that help frame a diamond-shaped attic louver. An exterior brick chimney on the north elevation is engaged but still breaks through the eaves. The exterior of the dwelling is clad in vinyl siding. Fenestration is symmetrically arranged, with three bays of windows and the front door, aligned horizontally and vertically. The second floor has three six-over-six, double-hung, wood-sash (possibly original) windows with aluminum storm windows and louvered, inoperable shutters. The first floor has two wood walk-out windows dating to the late nineteenth century in the north and center bays, each with door shutters. The main entrance in the south bay consists of a wood door with two vertical panels (late nineteenth century) opening below a transom and between two-pane sidelights over a recessed panel. Green fabric awnings cover the entrance and windows. The entrance is accessed via a concrete porch with metal railings and a brick landing. The house has a stone foundation.

The north elevation faces onto the property drive. The asphalt-shingled roof and the attached brick chimney are major features of the elevation. The vinyl-clad walls feature a rank of windows on either side of the chimney. The windows are six-over-six, double-hung, wood-sash (possibly original) units with louvered, inoperable shutters.

Survey Name: Cranbury CLG Survey 2017

Surveyor: Kristen Herrick

Organization: RGA, Inc.

☒ (Primary Contact)

Property ID:

-1907133494

Page 1

The south elevation repeats the cladding materials of the main elevation: asphalt shingles on the roof and vinyl-clad frame walls. The molded cornice is visible on this elevation. The wall surface contains two ranks of windows separated by a wide expanse of wall surface. The windows are six-over-six, double-hung, wood-sash (possibly original) units with louvered, inoperable shutters.

A one-story, L-shaped addition abuts the main block to the south and east. The addition was constructed in several campaigns, and the various rooflines of the individual sections do not match. An octagonal bay is located on the south elevation of the addition. Overall, the addition has a nearly flat roof, and its frame walls are clad with vinyl siding. Windows vary in size and shape; they are multi-light units that all appear to be late twentieth century replacement vinyl sash units. The addition has a concrete foundation, and brick steps in the rear access a door not visible from the public right-of-way.

Character defining elements of the dwelling include return cornices on the front (northwest) elevation and sidelights flanking the entrance.

History:

The 1916 Sanborn Atlas shows the main block of the house with a one-story rear addition and a small outbuilding. At that time, the house had a porch on the main elevation. The 1933 Sanborn Atlas shows the main block with the front porch; the rear addition has been extended around the southeast corner, but the octagonal bay has not been added. Historic aerials show the house beginning in 1940. The one-story addition is not always clearly depicted; the earliest aerial showing the current configuration of the addition is 1979.

Setting:

The John Lewis House at 2 North Main Street is sited on an L-shaped parcel (Block 33, Lot 38) located on the east side of North Main Street in Cranbury Township, Middlesex County, New Jersey. The dwelling is oriented with its primary elevation facing northwest and is set back approximately 20 feet from North Main Street. The portion of the sidewalk which spans the west side of the parcel is paved with bricks. A paved driveway, shared with the dwelling at 6 North Main Street, leads east from North Main Street past the subject dwelling's northeast elevation, terminating at a one-story detached garage located northwest of the dwelling. Shrubs about the dwelling's northeast and northwest elevations, with other small shrubs planted throughout the property. The parcel adjoins the northwest corner of Brainerd Lake. The John Lewis House at 2 North Main Street is located in a primarily residential neighborhood, surrounded by residential properties dating to the mid-nineteenth to the early twentieth century.

**Registration
and Status
Dates:**

National Historic Landmark?: ☐

National Register: 9/18/1980

New Jersey Register: 8/9/1979

Determination of Eligibility: 3/25/1977

Certification of Eligibility:

SHPO Opinion:

Local Designation: 9/26/1988

Other Designation:

Other Designation Date:

☐ **Eligibility Worksheet included in present survey?**

☐ **Is this Property an identifiable farm or former farm?**

Survey Name: Cranbury CLG Survey 2017

Surveyor: Kristen Herrick

Organization: RGA, Inc.

☒ (Primary Contact)

Property ID:

-1907133494

Page 2

Location Map:

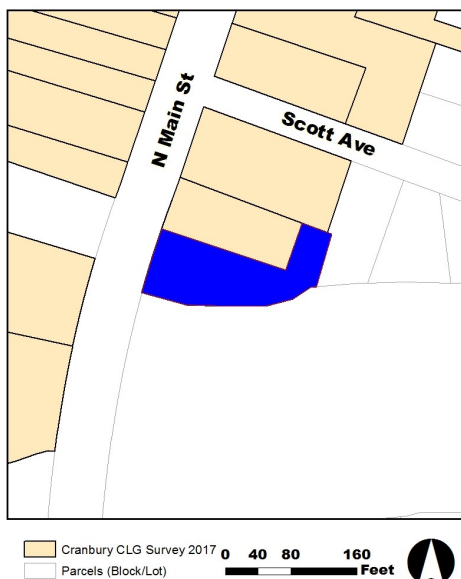

Site Map:

BIBLIOGRAPHY:

Author:	Title:	Year:	HPO Accession #:	(if applicable)
Walsh, Ruth	National Register of Historic Places Nomination for the Cranbury Historic District, Cranbury Township, Middlesex County, New Jersey	1979		
Heritage Studies	Preserving Historic Cranbury Village	1989		

Additional Information:

The 1989 Heritage Studies survey identified the John Lewis House at 2 North Main Street as a contributing resource to the Cranbury Historic District. RGA concurs with the previous evaluation and recommends the John Lewis House at 2 North Main Street as a contributing resource due to its date of construction and design.

More Research Needed? ☐ (checked=Yes)

INTENSIVE-LEVEL USE ONLY:

Attachments Included: 0 Building 0 Bridge
0 Structure 0 Landscape
0 Object 0 Industry

Historic District ? ☒

District Name: Cranbury Historic District

Status: Contributing

Associated Archeological Site/Deposits? ☐

(known or potential sites. If Yes, please describe briefly)

Conversion Problem? ☐ ConversionNote: 23

Date form completed: 6/21/2017

Survey Name: Cranbury CLG Survey 2017

Surveyor: Kristen Herrick

Organization: RGA, Inc.

☒ (Primary Contact)

Property ID:

-1907133494

Page 3