

## PROPERTY REPORT

Property ID: 1827122880

**Property Name:** 2 Evans Drive  
**Address:** 2 EVANS DR  
**Ownership:** Private  
**Apartment #:**  
**ZIP:** 08512

### PROPERTY LOCATION(S):

County:	Municipality:	Local Place Name:	USGS Quad:	Block:	Lot:
MIDDLESEX	Cranbury township			33	40

### Property Photo:



**Old HSI Number:** **NRIS Number:** **HABS/HAER Number:** 93

### Description:

PS&S recommends that 2 Evans Drive, constructed circa 1925-1930, is a contributing property in the Cranbury Historic District.

The 2 1/2-story, side gable-roofed, rectangular-plan main block of this painted wood clapboard-clad, Colonial Revival style frame dwelling on a parged foundation is 5-bays wide and 2 bays deep and is flanked by 1-story, hipped-roofed volumes with roofline railings on both its east and west. 2 gabled dormers with round-arch, multi-light sash windows are located on the north roof slope. Smaller, shed-roofed dormers with single-light windows are located on the south roof slope. The roofs are predominantly clad in asphalt shingle and the windows predominantly have 6/1, historic wood sash with historic shutters composed of a louvered lower panel and a solid upper panel with decorative, crescent-shape cutouts. A broad exterior, painted brick chimney centered on the west elevation. The primary entrance fronted by a concrete landing with historic, wrought iron railings, is centered on the north, water-facing elevation, and includes a historic screen door, a historic single-light door, and a historic door surround with a dentiled broken pediment with a central urn. The remaining bays are regularly fenestrated. The east side volume is lighted by a double window. The west side volume is lighted by a 20-light fixed window flanked by 10-light casement windows. The west elevation, only partially visible from the public right-of-way, is lighted by 2 windows on the second floor and 2 multi-light, quarter-round windows on the third floor. The east elevation is lighted by 2 windows on the second floor and a multi-light round window on the third floor. The south, street-facing elevation is only partially visible from the public right-of-way and includes a 9-light door with single-light transom and flanking 4/1 sash windows in the east volume.

**Survey Name:** Cranbury Local Historic District Survey 2018

**Principal Investigator:** Emily Cooperman

**Organization:** Paulus, Sokolowski & Sartor

**Property ID:**

Page 1

☐ (Primary Contact)

1827122880

The residence at 2 Evans Drive was not documented in the 1980 National Register of Historic Places Nomination for the Cranbury Historic District. It was evaluated in the 1989 Heritage Studies inventory as key-contributing in the district, but the reasoning for this evaluation is not clear, since, although clearly a contributing property, it is not sufficiently distinguished as a Colonial Revival design for this exceptional status. The earliest documentation of the residence is the 1933 Sanborn map, which depicts the residence as a 2-story, frame dwelling with a 1-story, full-width porch on the west elevation, a 1-story volume on the east elevation, and a basement garage. At this point, the house was part of the 1 South Main Street property. The 1974 photographic inventory of Cranbury historic buildings in the collection of the Cranbury Historical and Preservation Society shows the south elevation of the residence with a central entry and door hood, 6/1 sash windows, a 3-sided projecting bay with 6/6 sash east of the door, and secondary entrances in both side volumes. Aerial photographs and visual evidence indicate do not indicate any major construction campaigns since the residence's construction.

This property is a contributing property in the historic district because it retains integrity and historic, character-defining features such as its historic massing and fenestration patterns, historic wood windows and shutters, historic clapboard, historic wood doors, historic dormers and side porches, historic wrought iron entrance railings, and its historic chimney.

**Setting:**

Evans Drive is an approximately 1/2-mile long road that connects S. Main Street, to the west, to Station Road, to the south. The tree-lined, residential road is the first road on the south side of Brainerd Lake and is predominantly bordered by single-family dwellings of moderate size.

**Registration  
and Status  
Dates:**

National Historic Landmark?: ☐

National Register: 9/18/1980

New Jersey Register: 8/9/1979

Determination of Eligibility: 3/25/1977

Certification of Eligibility:

**SHPO Opinion:**

Local Designation: 9/25/1988

Other Designation:

Other Designation Date:

☐ Eligibility Worksheet included in present survey?

☐ Is this Property an identifiable farm or former farm?

**Location Map:**

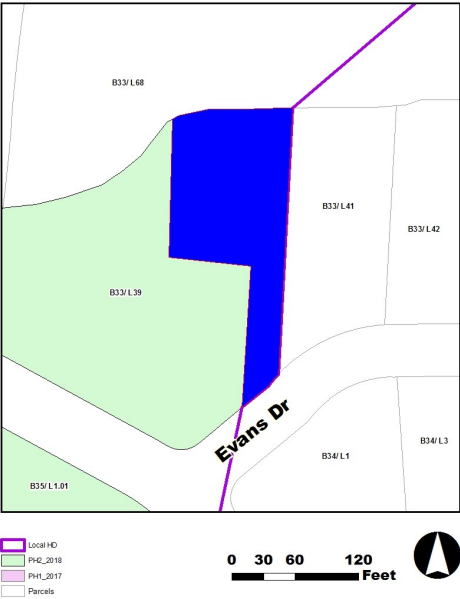

**Site Map:**



**BIBLIOGRAPHY:**

Author:	Title:	Year:	HPO Accession #:	(if applicable)
Brennan, Peggy and Frank J. Jr.	Images of America: Cranbury, Volume II	1998		
(None Listed)	Aerial and street view photography for 1931, 1940, 1947,			

**Survey Name:** Cranbury Local Historic District Survey 2018

**Principal Investigator:** Emily Cooperman

**Organization:** Paulus, Sokolowski & Sartor

☐ (Primary Contact)

**Property ID:**

1827122880

Page 2

1953, 1957, 1963, 1969, 1970, 1972, 1979, 1987, 1995, 2002, 2006, 2007, 2008, 2010, 2012, 2013, and 2015 available at [historicaerials.com](http://historicaerials.com) and for 1995, 2002, 2006, 2007, 2008, 2010, 2013, 2016, and 2017 available through Google Earth

Chambers, John Whiteclay II	Cranbury: A New Jersey Town from the Colonial Era to the Present	2012
(None Listed)	1876 Everts and Stewart Map	1876
Walsh, Ruth	National Register of Historic Places Nomination for the Cranbury Historic District, Cranbury Township, Middlesex County, New Jersey	1979
(None Listed)	1850 Otley and Keily Map	1850
(None Listed)	1933 Sanborn Map	1933
(None Listed)	1916 Sanborn Map	1916
Brennan, Peggy and Frank J. Jr.	Images of America: Cranbury	1995
Heritage Studies	Preserving Cranbury Township	1989

**Additional Information:**

1202\_33\_40 / 2STY SFD / 1929

**More Research Needed?** ☐ (checked=Yes)

---

**INTENSIVE-LEVEL USE ONLY:**

<b>Attachments Included:</b>	0 Building	0 Bridge
	0 Structure	0 Landscape
	0 Object	0 Industry

**Historic District ?** ☒

**District Name:** Cranbury Historic District

**Status:** Contributing

**Associated Archeological Site/Deposits?** ☐

(known or potential sites. If Yes, please describe briefly)

---

Conversion Problem? ☐ ConversionNote:

Date form completed: 8/27/2018

---

**Survey Name:** Cranbury Local Historic District Survey 2018

**Principal Investigator:** Emily Cooperman

**Organization:** Paulus, Sokolowski & Sartor

**Property ID:**

☐ (Primary Contact)

**1827122880**

Page 3